

T 5N., R. 28E., W. M.

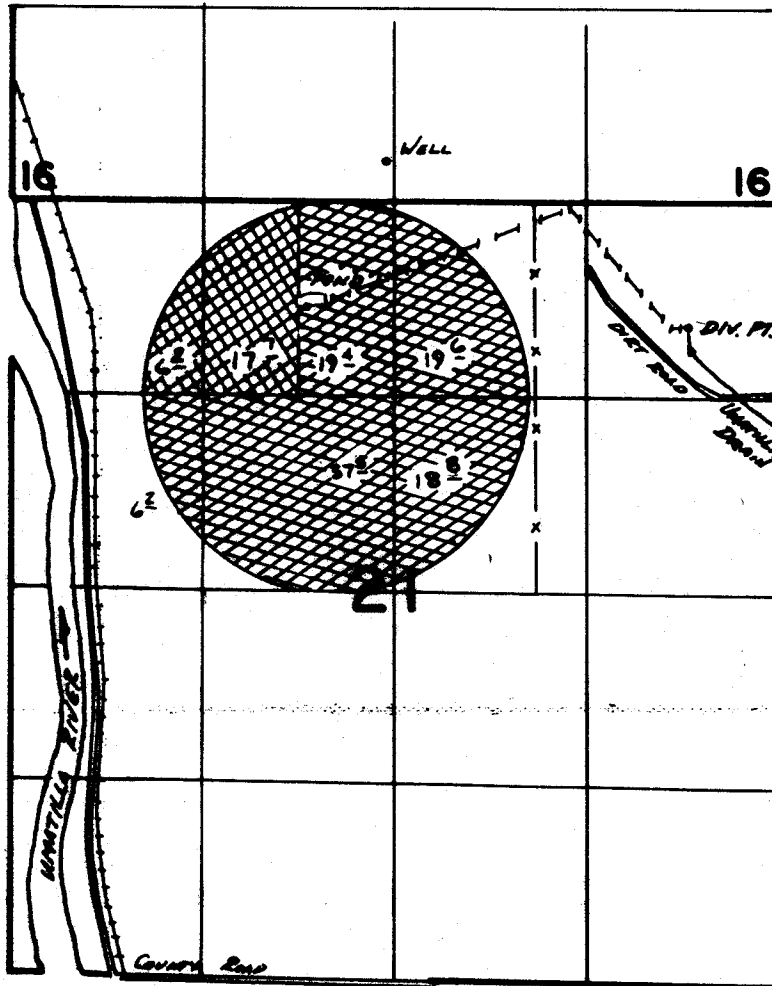

Well Loc: 270' N. + 60' W. FROM S 1/4 COR. SEC 16

Div. Pt. Loc: 840' S. + 620' W. FROM NE COR. SEC. 21

**FINAL PROOF SURVEY**  
UNDER

55327                      41489

G-6767                      G-6848

Application No. G-7799... Permit No. G-7231.....

IN NAME OF

.....**STUART BONNEY**.....

Surveyed March 1, 1988, by *V.K. Church*.....

 SUPPL PER. 41489

 SUPPL PER. G-7231

 SUPPL PER. G-6848