

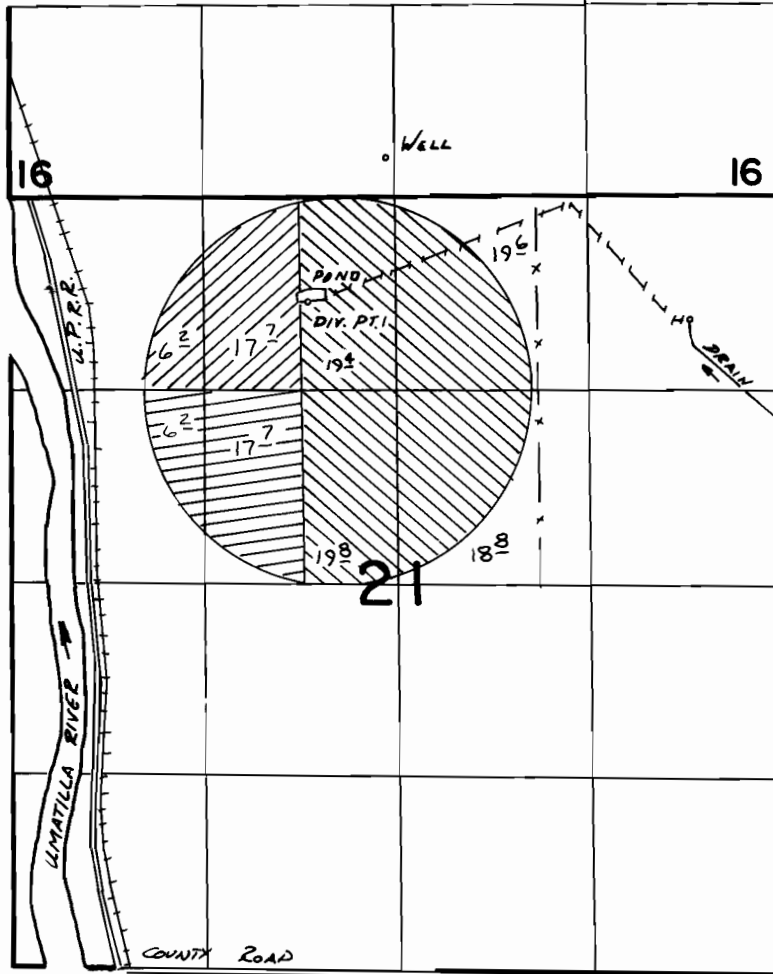



T. 5N., R. 28E. W.M.



Div. Pt. 1 Loc: 720'S. & 600'W. FROM N¹/₄ COR. SEC 21

FINAL PROOF SURVEY
UNDER

-  PRIM. PER. 39369
-  SUPPL.
-  PER. 39379

Application No. **53479** Permit No. **39379**
52467 Permit No. **39369**
IN NAME OF

STUART BONNEY

Surveyed *March 4*, 19*82*., by *V.L. Church*.....