

34976

TOWNSHIP 3N., RANGE 27E., W.M.

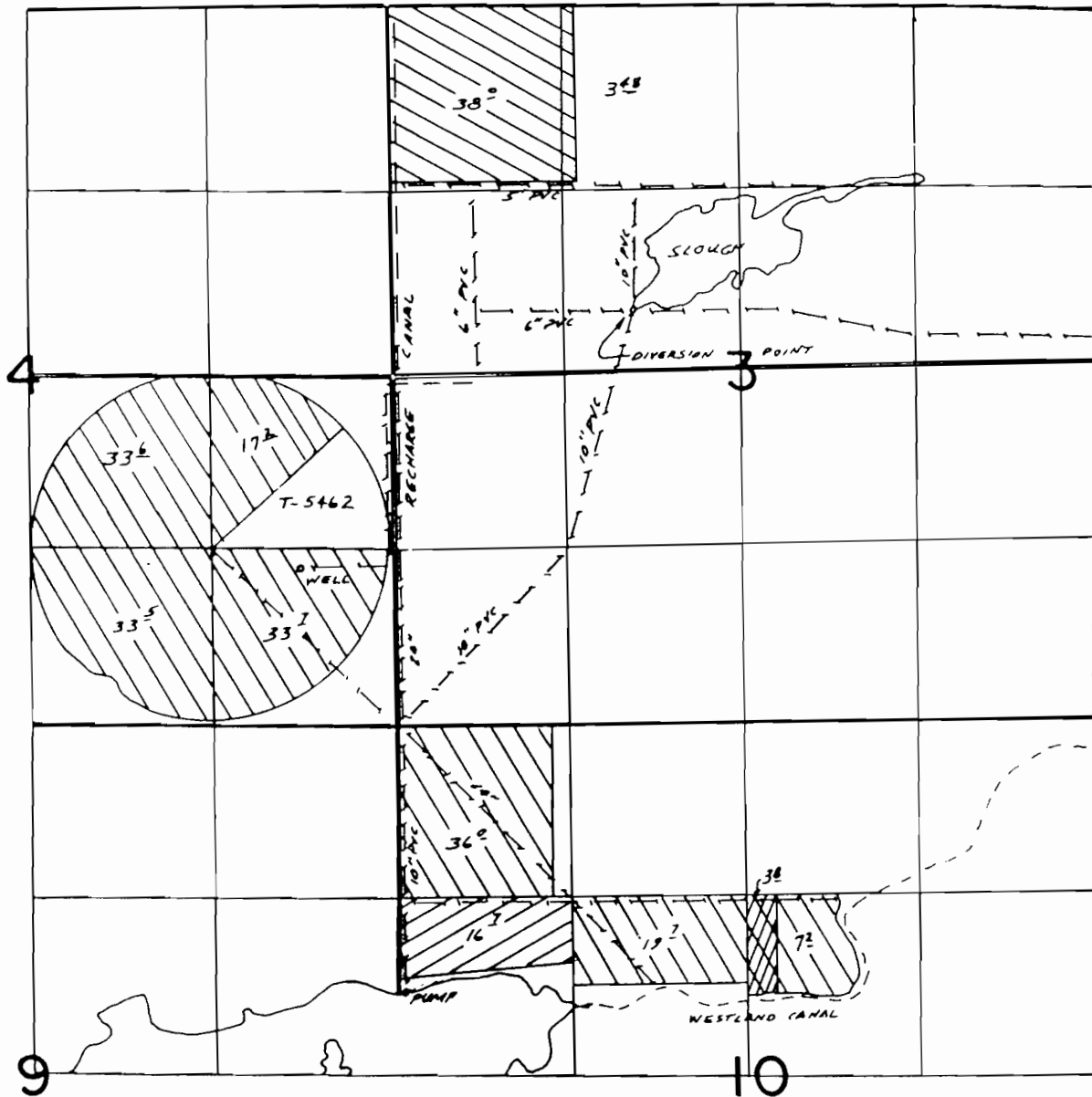

UMATILLA R. DIVERSION POINT LOCATED N. $76^{\circ} 45' 56''$ E. 2913.19' FROM W. $\frac{1}{4}$ COR. SEC. 21
 SLOUGH DIVERSION POINT LOCATED $460' N$ & $1800' E$ FROM W. $\frac{1}{4}$ COR SEC 3

FINAL PROOF SURVEY

UNDER

APPL. 45883 PER. 34976
 48181 35712 ✓

IN NAME OF

TRI-SET, INC & WESTLAND I.D.

SURVEYED DEC 6, 1977 BY R. BARWIN