

TOWNSHIP 3N., RANGE 27E., W.M.

RECEIVED
MAY 1 1986
WATER RESOURCES DEPT
SANTA FE COUNTY

T. 3N. R. 29E. W.M.

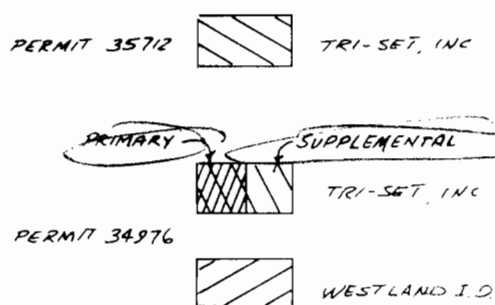
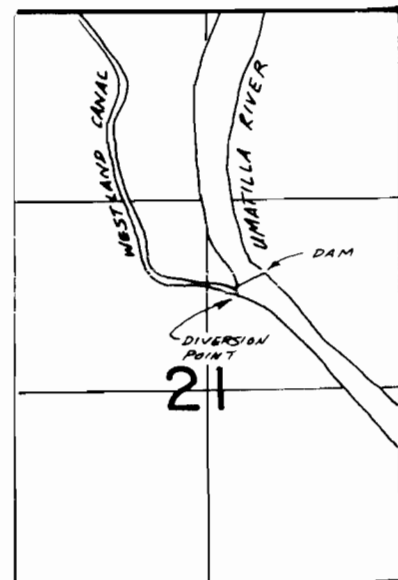
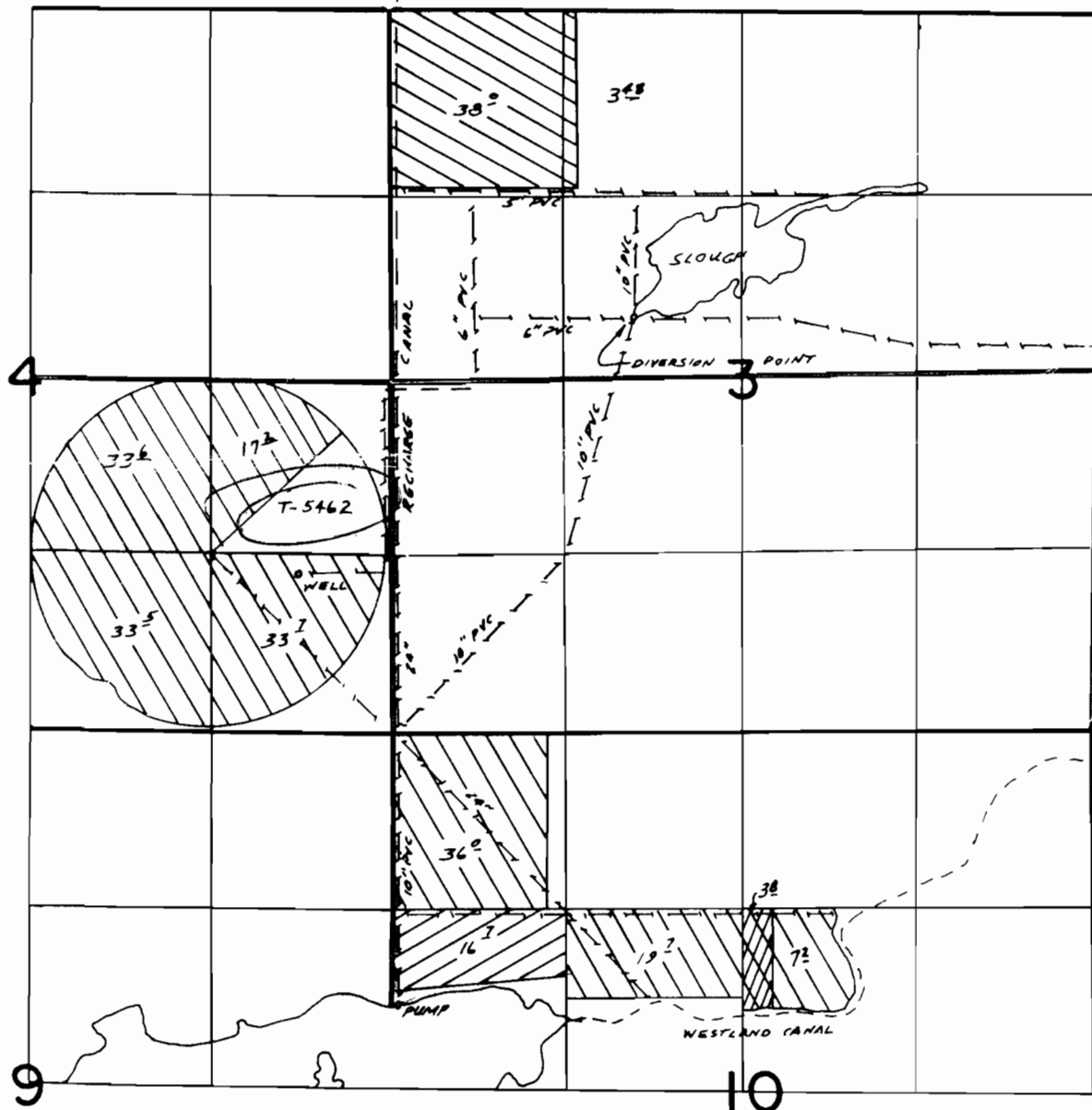

UMATILLA R. DIVERSION POINT LOCATED N. 76° 45' 56" E. 2913.19' FROM W. 1/4 COR. SEC. 2.
SLOUGH DIVERSION POINT LOCATED 460' N + 1800' E. FROM W. 1/4 COR SEC 3

FINAL PROOF SURVEY
UNDER

APPL. 45883 PER. 34976
48181 35712

IN NAME OF
TRI-SET, INC & WESTLAND I.D.