

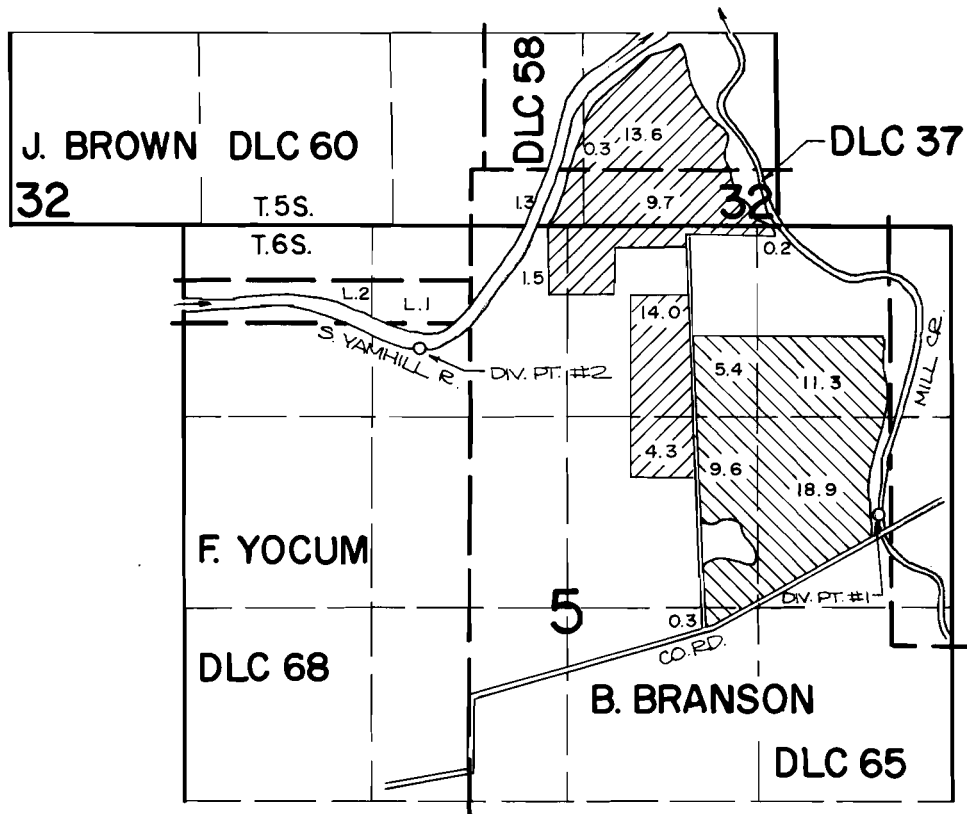

T.5&6S., R.6W., W.M.



DIV. PT. #1 LOC.: 1990 FT. S. AND 490 FT. W.; DIV. PT. #2 LOC.: 850 FT. S. AND 3660 FT. W.; BOTH FROM THE N.E. CORNER OF SECTION 5.

 MILL CR.

 S. YAMHILL R.

FINAL PROOF SURVEY UNDER



SCALE: 4" = 1 MILE

Application No. 58644 Permit No. 44147
IN NAME OF

ROBERT & BARBARA WOODCOCK

Surveyed OCT. 3, 1984, by *P. Paster*