

T. 11 S., R. 2 W., W. M.

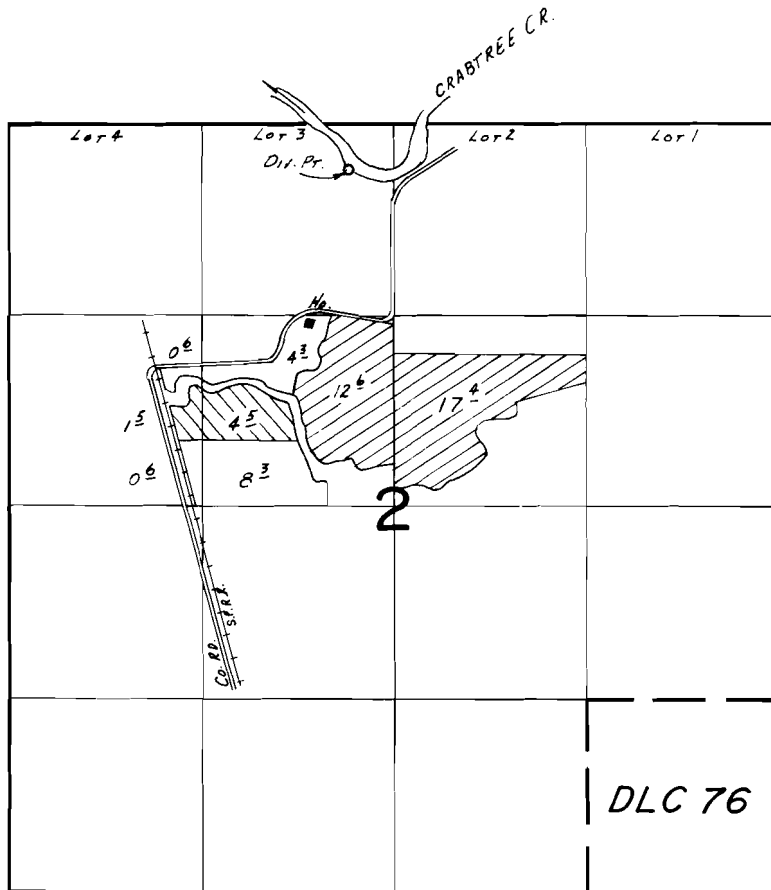

Div. Pr. Loc: 2310' N. & 300' W. FROM CENTER 1/4 COR. SEC. 2.

SCALE: 1" = 1320'

FINAL PROOF SURVEY
UNDER

54041 40418
Application No. 61.3.4.4... Permit No. 45639.....
IN NAME OF



..... HAROLD K. REILEY

Surveyed MAY..28.. 19.82, by L.M.TOLL.....