



(Robert L. Graham)

SEC. 34 T. 2. S. R. 2. P. 1. W. 6.

Application No. 8423
Permit No. 5536

8455

N. Y. S. Line between Secs. 30 & 31
400'

1800' 5.85' 30 E.

I, Ralph E. Schott, do hereby certify that This Map was made from notes taken during an actual Survey made by me on May 23, 1922, and that it correctly represents the works described in the accompanying application, together with the location of Streams and other ditches in the immediate vicinity.

Ralph Schott
County Surveyor of Gilliam County

Scale: 1" = 400'

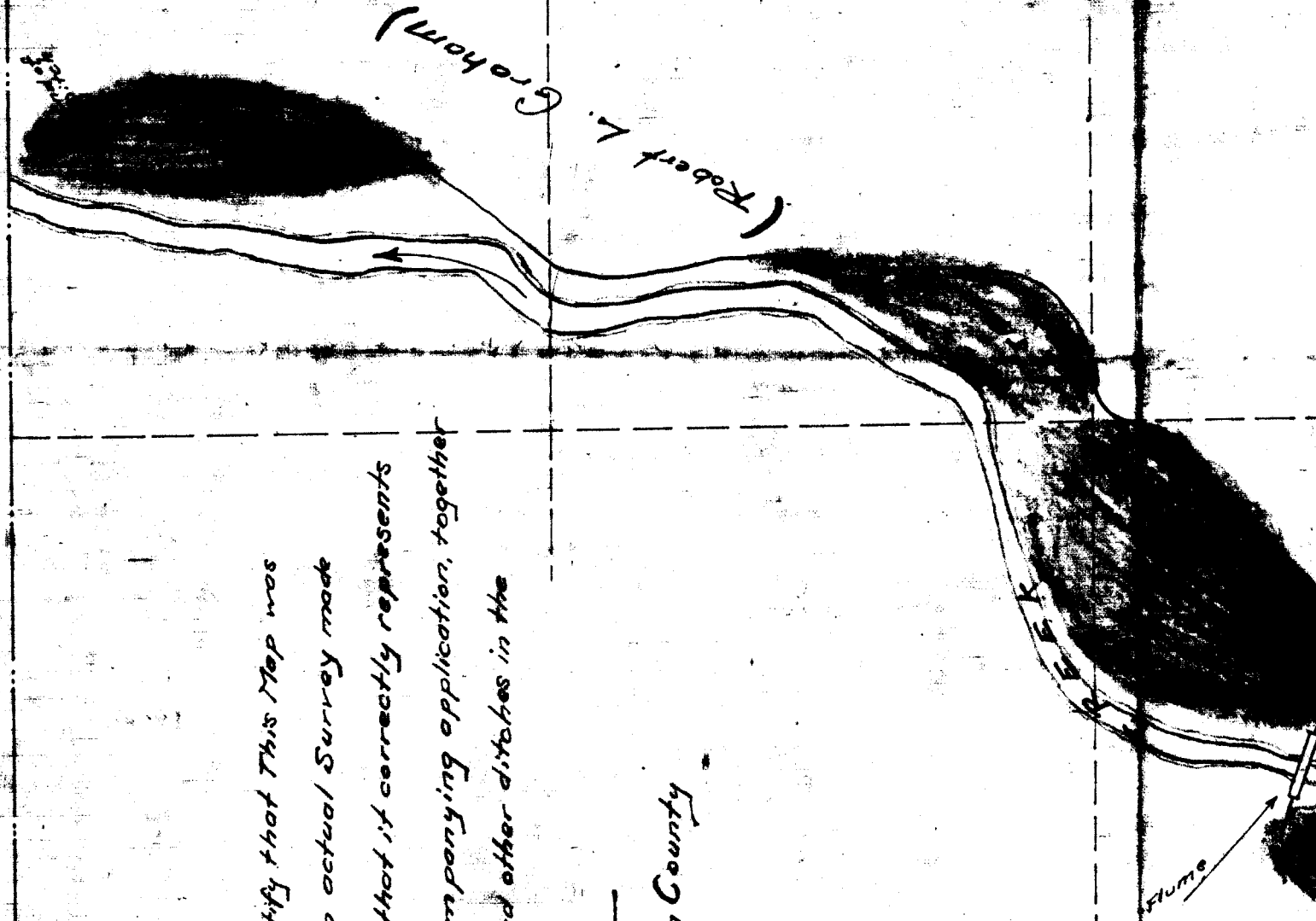

RTS

RTS

WERN. SECT. 30 T. 34
X CO. 1