

69191

53259

T. 2N., R. 33E., W. M.

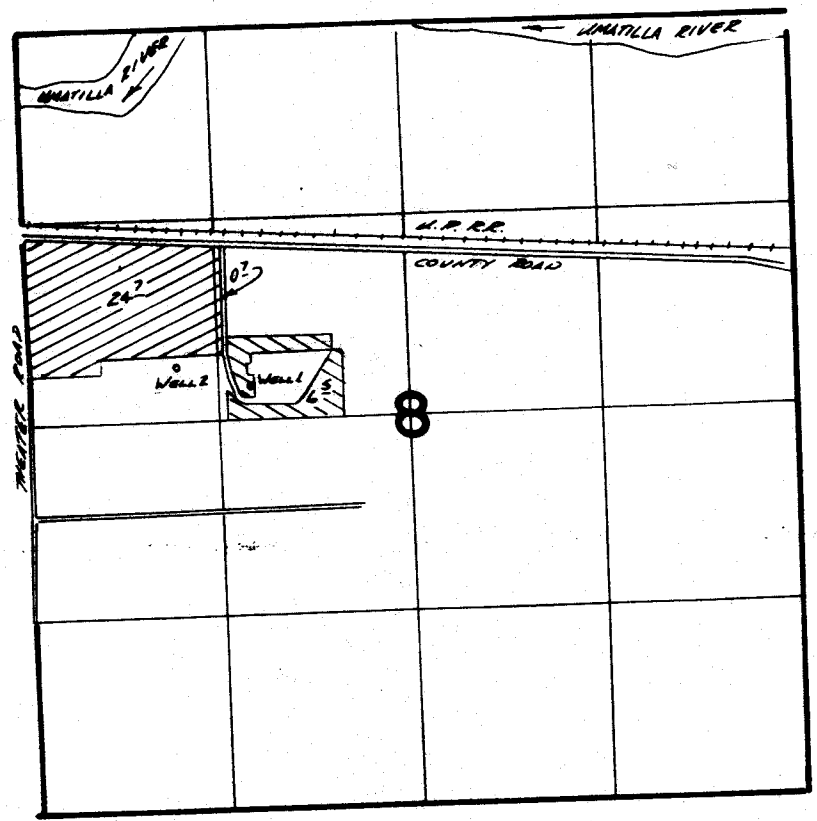

Well 2 Loc: 376' N + 1030' E FROM W 1/4 COR. SEC. 8
 Well 1 Loc: 230' N + 1540' E FROM W 1/4 COR. SEC. 8

FINAL PROOF SURVEY
 UNDER

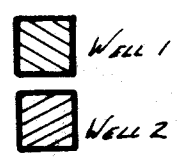

Application No. **G:10120** Permit No. **G:9191**.....
 IN NAME OF

JOHN L. & ELOISE J. KILBY.....

Surveyed Aug 4..... 1982, by J. L. Church.....