

T. 13S. R. 33E. W.M.

Application No. 58484

Permit No. 44043

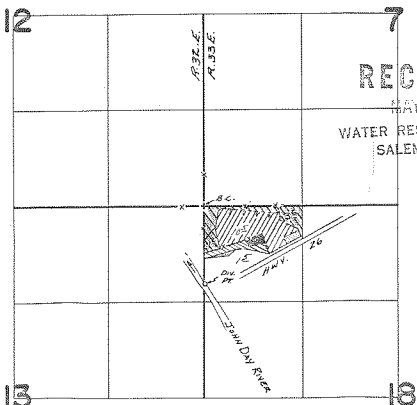



RECEIVED
 MAY 02 1979
 WATER RESOURCES DEPT.
 SALEM, OREGON

Div. Pt. Loc. - 1090'S / 30'E from NW cor. Sec. 18

new application

FINAL PROOF SURVEY UNDER

-  - MITCHELL
-  - MOODY
-  - Under Cert # 25445

Application No. 48700 Permit No. 36513...
IN NAME OF

DAVID MOODY

Surveyed Aug. 25 1976, by J.S. Donaldson...