

T. 5N. R. 29E. W.M.

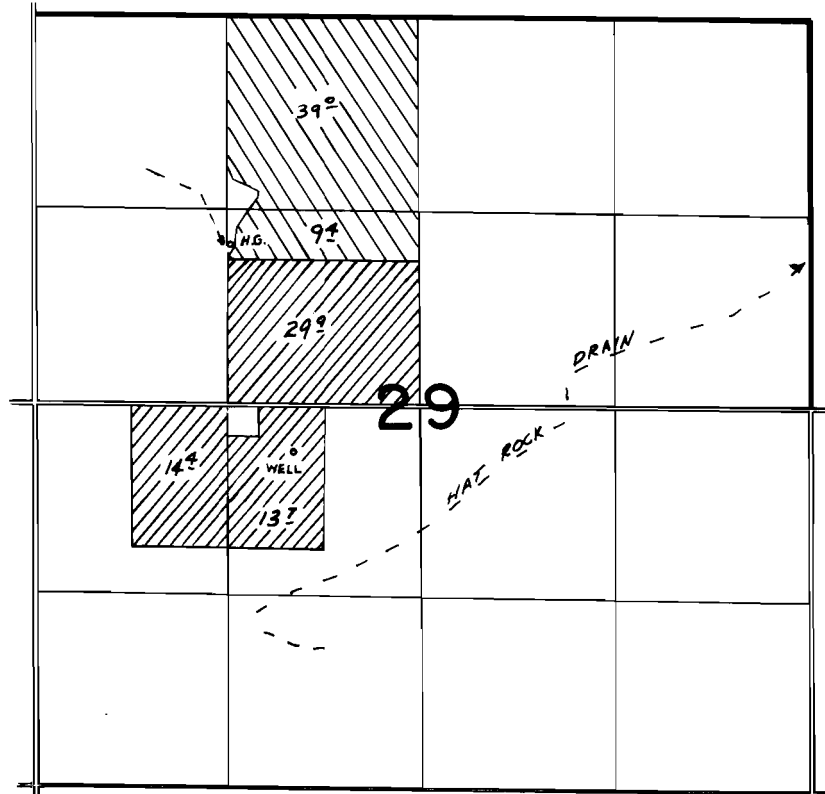

WELL LOC. 320'S & 1770'E FROM W1/4 COR. SEC 29



Supplemental



Primary

FINAL PROOF SURVEY
UNDER

Application No. G-6438 Permit No. G-6041
IN NAME OF

JOHNNIE M. MAYES

Surveyed 10-21 1978, by R. BARWIN