

G-81855
53392

T. 4 & 5N., R. 29E., W. M.

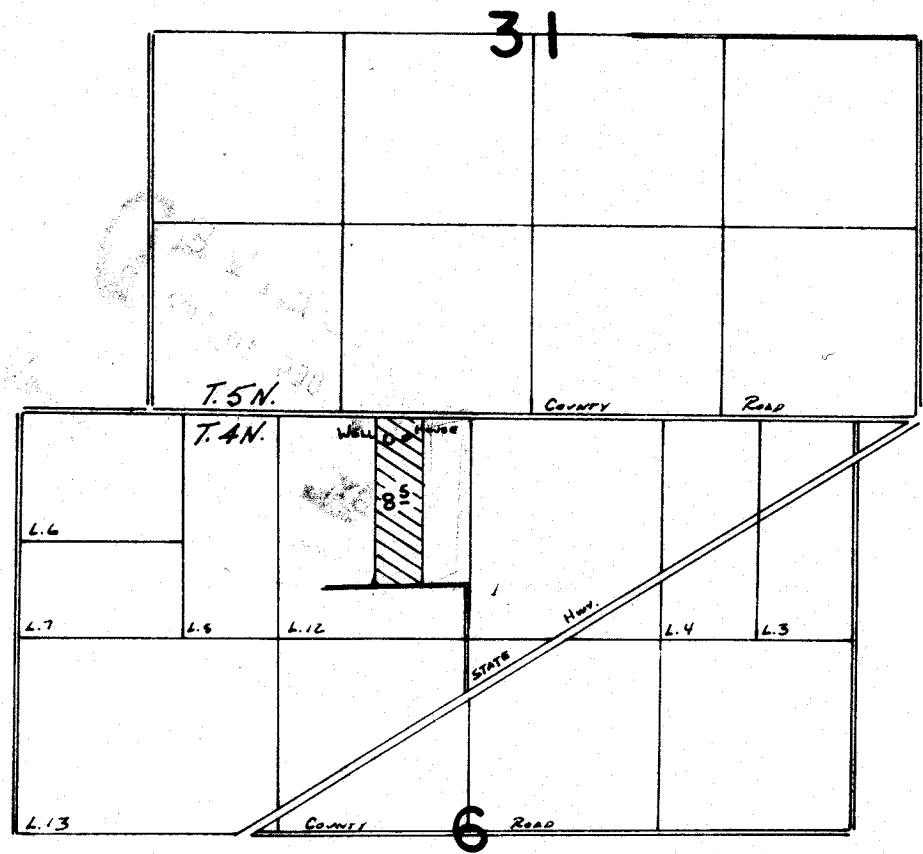

SCALE: 1" = 1320'

Well Located 130'S. & 560'W. From N1/4 COR. SECTION 6

FINAL PROOF SURVEY UNDER

Application No. **G:8797**. Permit No. **G:8185**...
IN NAME OF

MARSCHALL A. MOON

Surveyed 10.4.1978., by R. Barwin