

T. 4N., R. 29E., W. M.

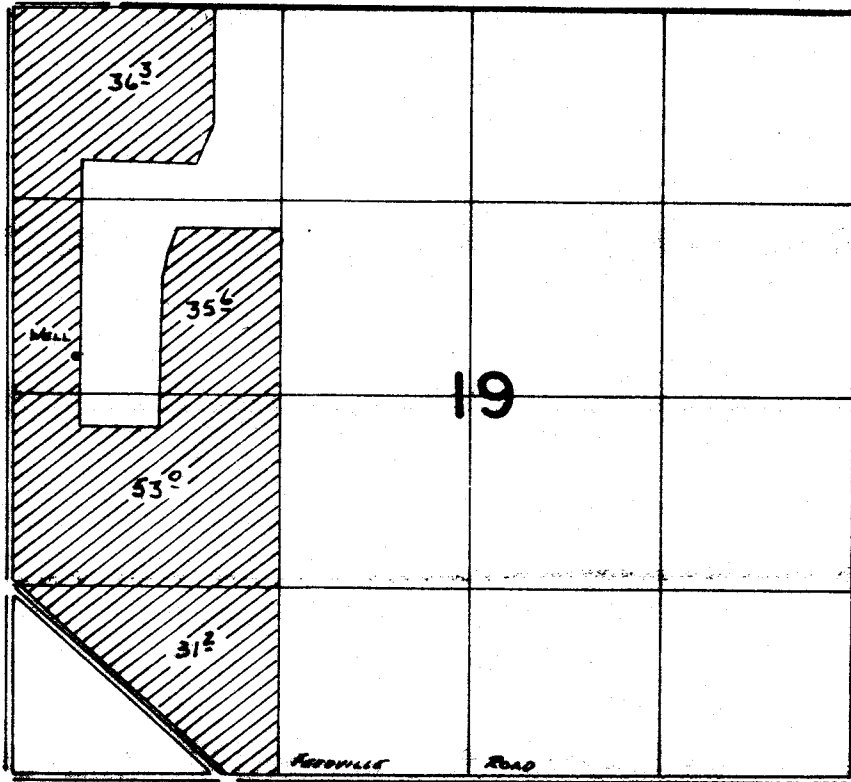

Well Loc: 250' N. + 450' E. FROM W 1/4 COR. SECTION 19

FINAL PROOF SURVEY
UNDER

Application No. **G-9407** Permit No. **G-8802**
IN NAME OF

LOYALTA, INC.

Surveyed Nov. 26, 1983, by *James A. Church*