

T. 2N., R. 32E., W.M.

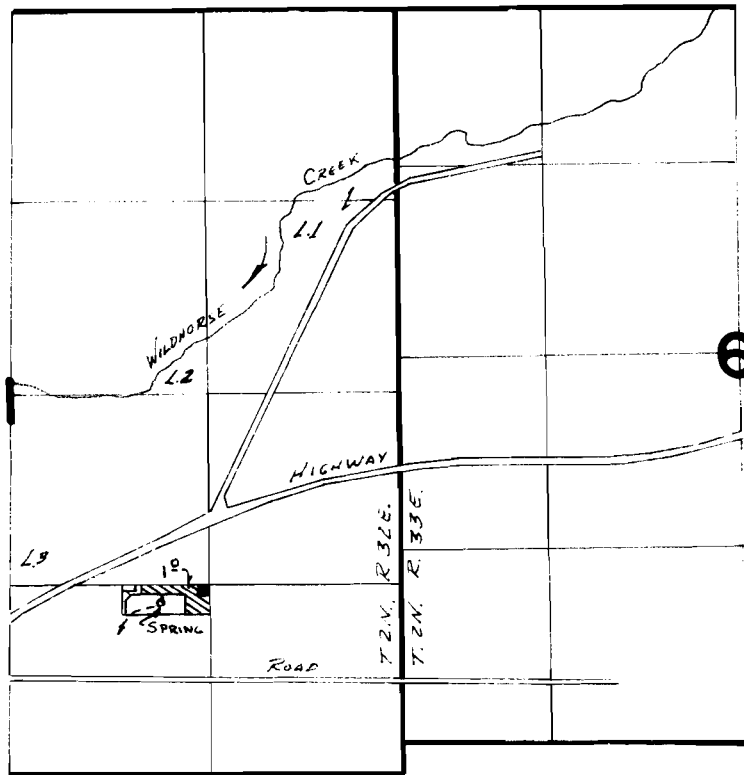

SPRING LOCATED 1180' N. & 1650' W FROM SE COR. SEC. 1

SCALE: 1" = 1320'

FINAL PROOF SURVEY
UNDER

Application No. **55678** Permit No. **41710**.....
IN NAME OF

.....**DORIS E. RICHARDS**.....

Surveyed ..11.30..... 19.79., by **V. J. CHURCH**.....