

T. 2S. R. 44E. W. M.

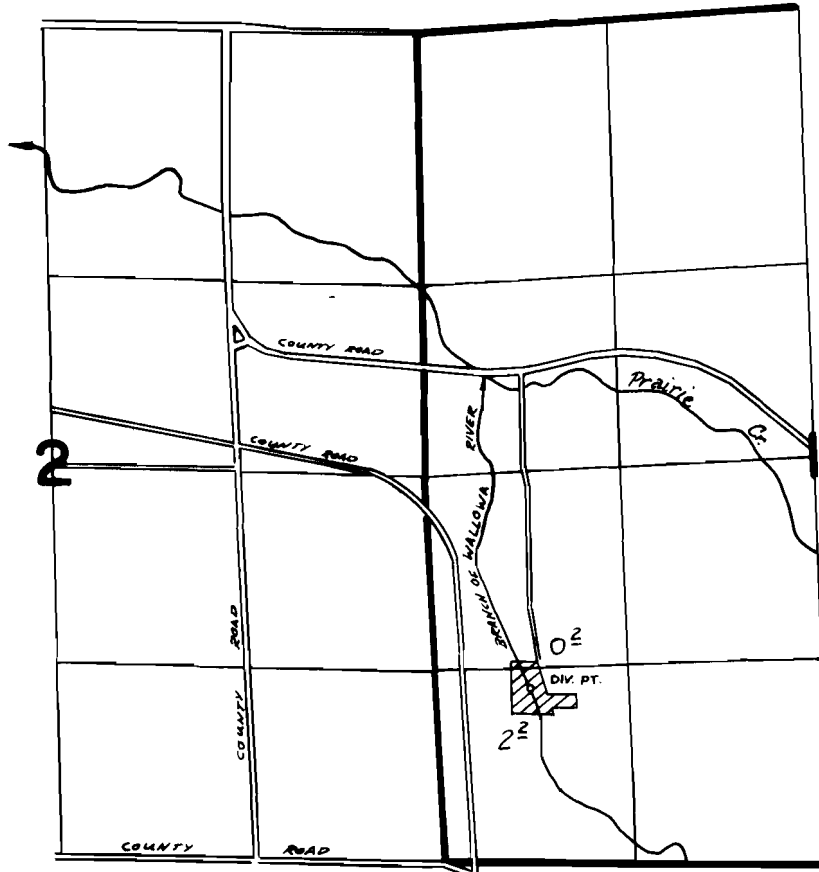

DIV. PT. LOC. 1200'N & 650'E FROM SW COR SEC 1

**FINAL PROOF SURVEY**  
UNDER

Application No. 53496..... Permit No. 39795.....  
IN NAME OF

**LAWRENCE & CYNTHIA STOCKDELL**

Surveyed 8:30..... 1978., by R. BARWIN.....