

T.1S. R.43E. W.M.

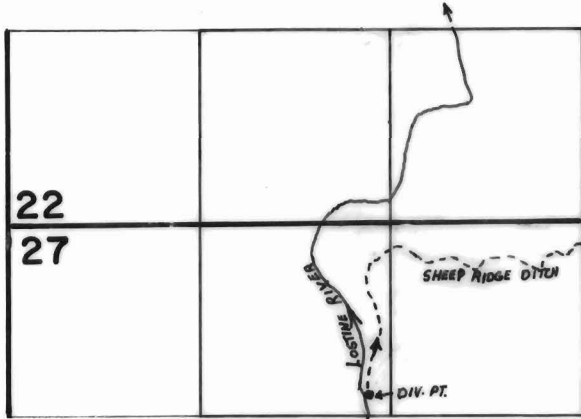

DIV. PT. LOCATED 1200' SOUTH AND
120' WEST FROM N 1/4 COR. SEC. 27

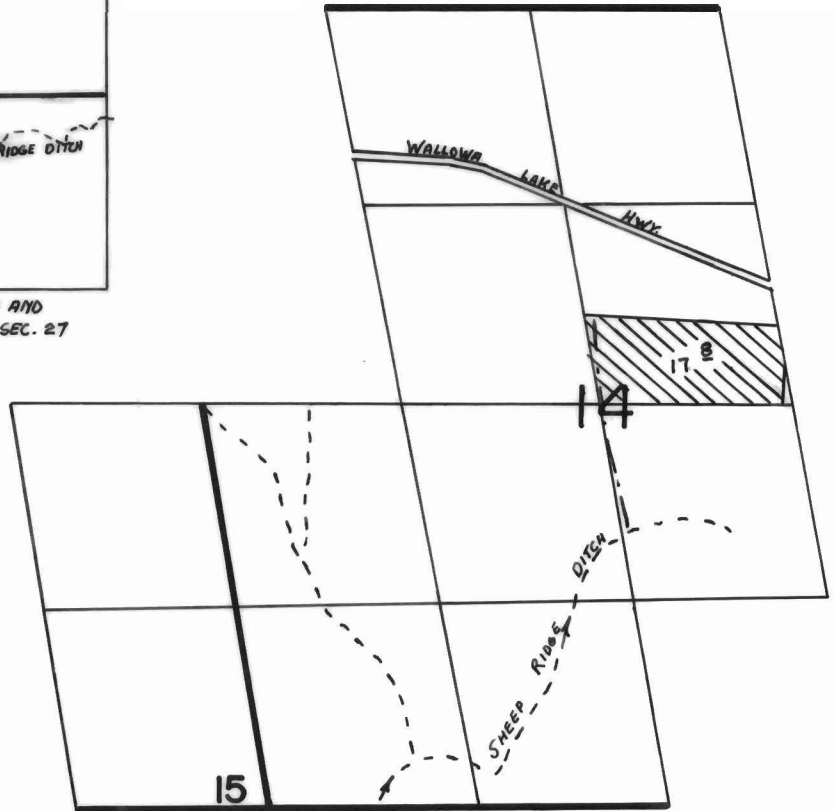

FINAL PROOF SURVEY
UNDER

Application No. **58005** Permit No. **43727**
IN NAME OF

RICHARD H. HAGANAH

Surveyed AUGUST 10, 1982, by V. L. Church