

T.5S.,R.7W.,W.M.

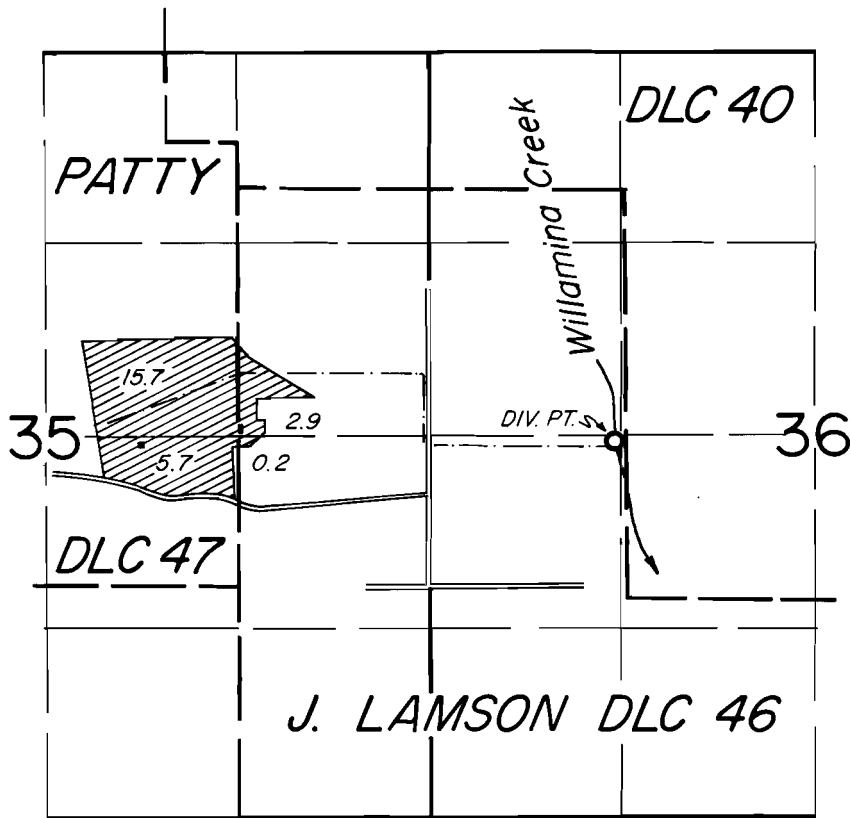

DIV. PT. LOC. 970' N. & 2580' E. OF SE. COR. DLC 47

FINAL PROOF SURVEY UNDER

Application No. 53312 Permit No. 39556....
IN NAME OF

.....FEDERAL LAND BANK OF SPOKANE.....

Surveyed June 21, 1979, by C. RODRIGUEZ

WB