

T. 5 S., R. 8 W., WM.

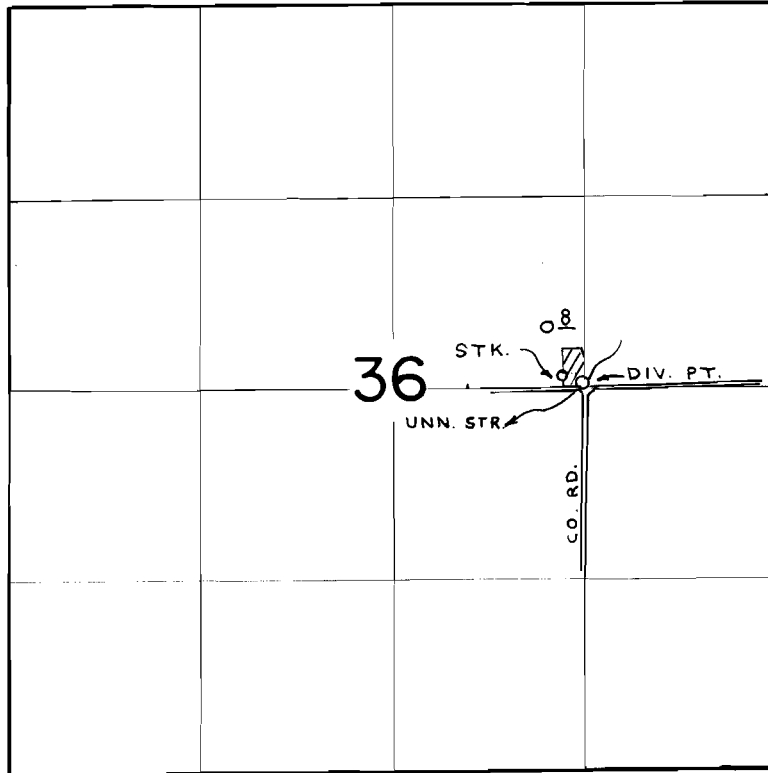

DIV. PT. LOC. 20' N. & 1350' W. OF E. 1/4 COR. SEC. 36



SCALE  
1" = 1320'

**FINAL PROOF SURVEY**  
UNDER

Application No. 58093 Permit No. 43825.....  
IN NAME OF

.....*Phillip I. & Jennifer Banner*.....

Surveyed NOV. 16, 1984, by P. PAGTER.....