

T.25S., R.18E., W.M.

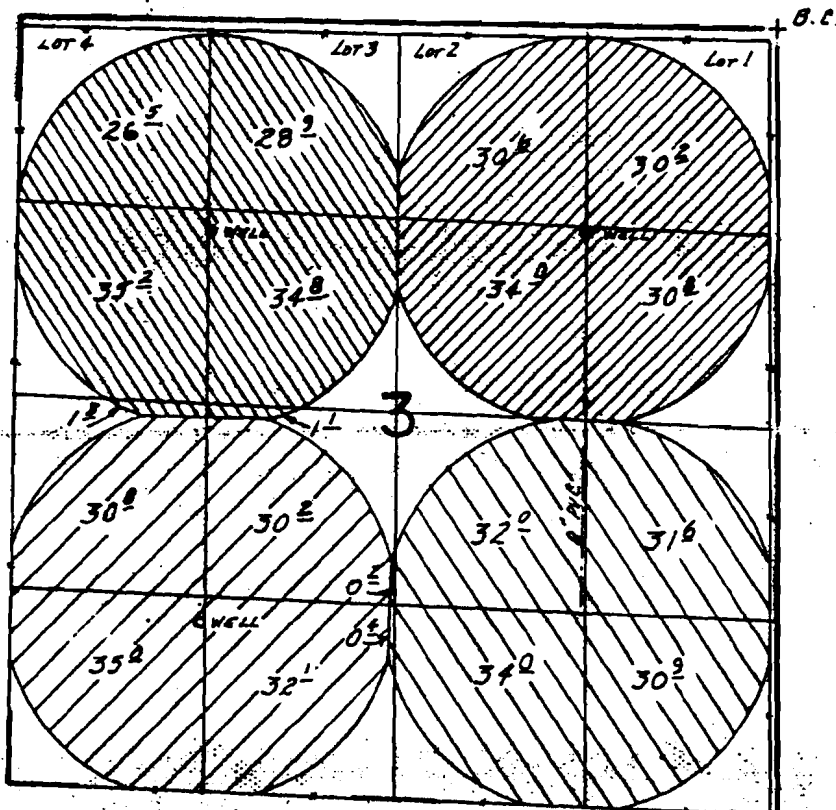

WELLS LOC.: 1400'S. & 1320' W., 1390'S. & 3900' W. AND 4050'S. & 3970' W., ALL FROM NE COR. SEC. 3.

SCALE: 1"=1320'

FINAL PROOF SURVEY

UNDER

G-8583

G-8684

G-10148

G-7994

G-8061

G-9262

Application No. G-10178.. Permit No. G-9312.....

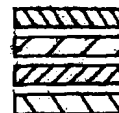

IN NAME OF

.....GILBERT L. CROWSON.....

Surveyed Oct. 14..... 1984, by B.W. BISHOP.....