

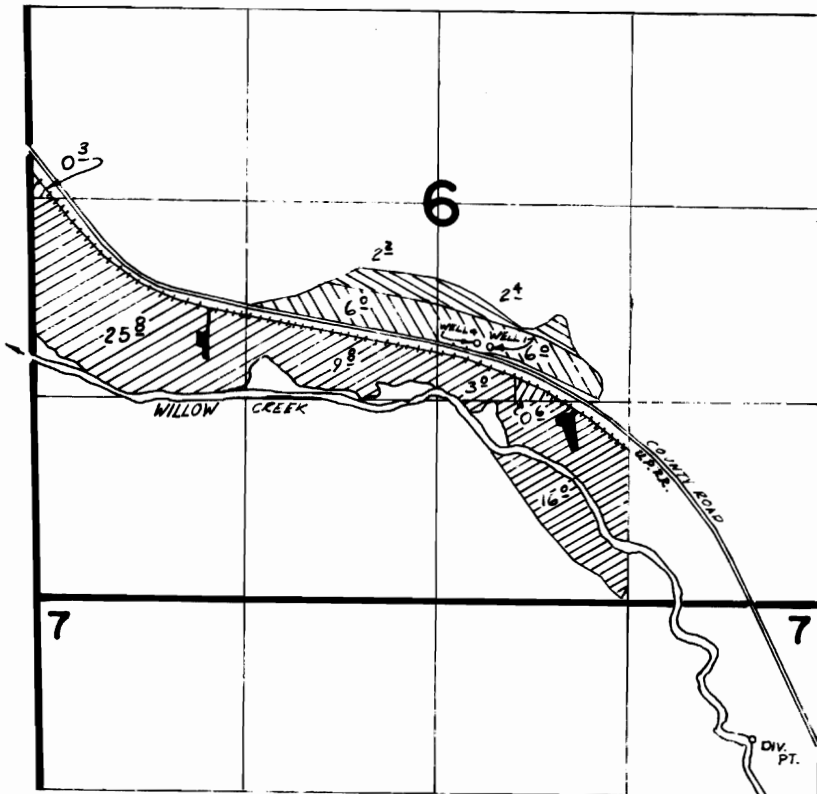



T. 2N. R. 23E. W. M.



DIV. PT. LOC. 930'S & 470'W FROM NE COR SEC 7
 WELL 1 LOC. 1750'N & 2300'W FROM SE COR SEC 6
 WELL 4 LOC. 1770'N & 2390'W FROM SE COR SEC 6

	WELL 1 PRI PER G-5192 WELL 4 SUPP'L PER G-5879		WELL 4 PRI PER G-5879		SUPP'L PER. G-5879
	PRI G-5879				

FINAL PROOF SURVEY
 UNDER

TRANSFER 3911, 4127, 4128
 G-5515 G-5192
 Application No. G-6232 Permit No. G-5879
 IN NAME OF

DAVID CHENEY

Surveyed 8-14 1977, by J. Church