

T. 6N. R. 35E. W.M.

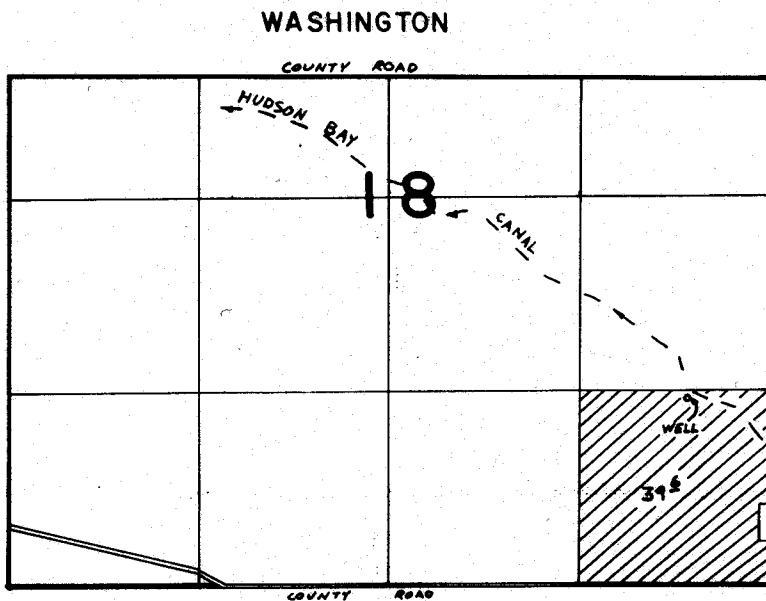

WELL LOC. 1270'N & 570'W FROM SE COR. SEC 18

FINAL PROOF SURVEY UNDER

Application No. G-6458.. Permit No. G-5264..
IN NAME OF

.....ROBERT A. DIXSON.....

Surveyed 9-20..... 1978., by R. BARWIN.....