

T. 4N. R. 29E. W. M.

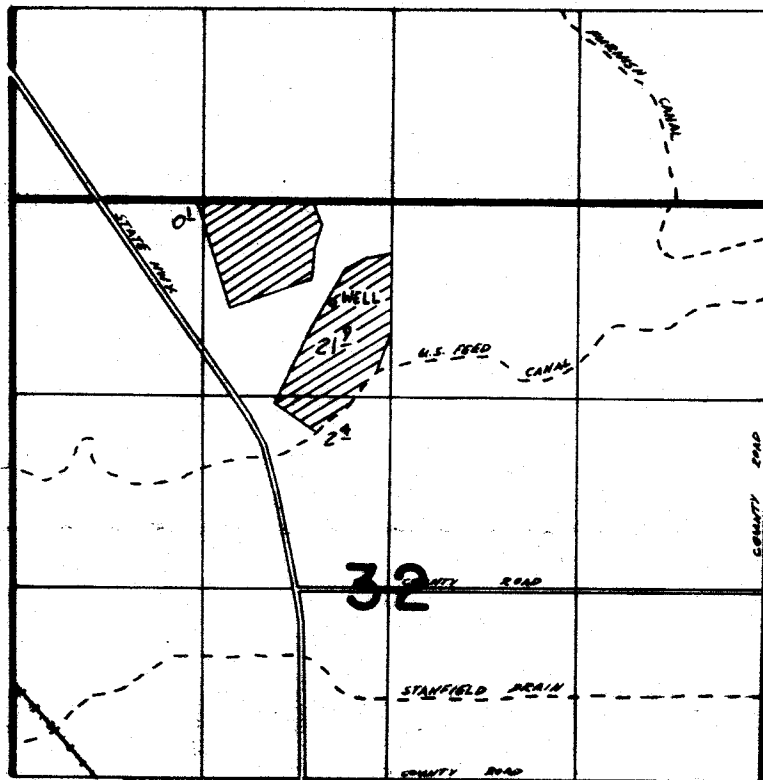

WELL LOC. 700'S / 2220'E FROM NW COR SEC 32

FINAL PROOF SURVEY
UNDER

Application No. **G-6439** Permit No. **G-6042**
IN NAME OF

SCOTT P. CRUIKSHANK

Surveyed 7-18 1979, by V. CHURCH