

G-7399⁵

53484

T. 4N. R. 29E. W.M.

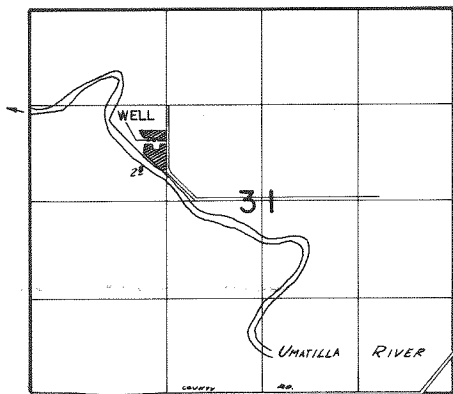

WELL LOCATED 850'N & 1720'E FROM W1/4 COR SEC 31

FINAL PROOF SURVEY
UNDER

Application No. G-7965... Permit No. G-7399
IN NAME OF

R. E. WAHNER

Surveyed 2-7 1979, by R. BARWIN