

T. 4N., R. 29E., W.M.

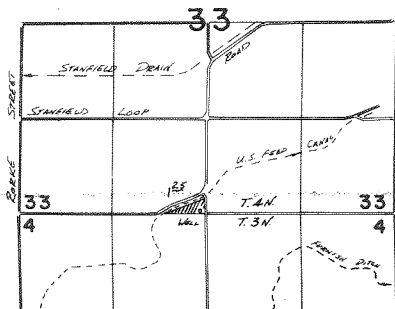

WELL LOCATED 40' N. & 80' W. FROM S $\frac{1}{4}$ COR. SEC. 33

FINAL PROOF SURVEY
UNDER

Application No. G-9353. Permit No. G-8629
IN NAME OF

RALPH R. BURKETT

Surveyed APR. 30 1982, by K. CURRY