

T. 4N., R. 29E., W. M.

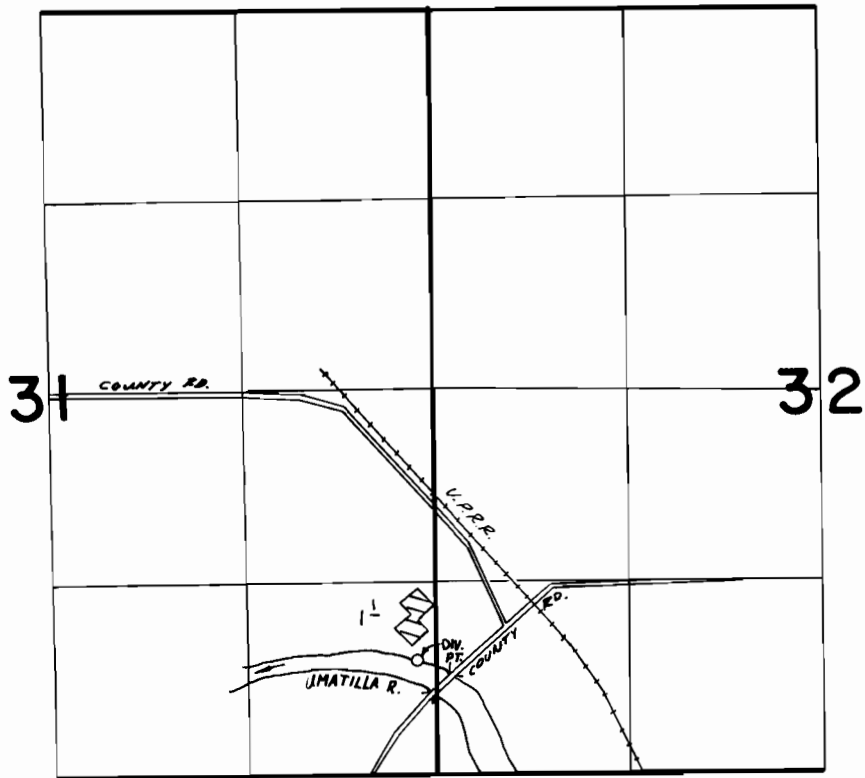

DIV. PT. LOCATED 790' N. & 130' W. FROM SE COR. SEC. 31 T. 4N. R. 29E.

FINAL PROOF SURVEY
UNDER

Application No. 50029 Permit No. 37612
IN NAME OF

OLEN BROCK

Surveyed July 18 1978, by V.L. Church