

WATER RIGHT SURVEY FOR ROY MAST, IN PORTIONS OF
 SW $\frac{1}{4}$ SW $\frac{1}{4}$, SECTION 33, TOWNSHIP 24 SOUTH, RANGE 11 WEST, W.M.
 Coos County, Oregon

RECEIVED

MAR 25 1975

STATE ENGINEER
 SALEM, OREGON

NOTE: Estimated spring flow -
 summer low $\frac{1}{2}$ gallon per minute
 winter high 2 gallons " "

Point of diversion is
 159.37 feet North
 and 356.80 feet east
 of Section Corner

Point of diversion is an
 un-named spring, hand dug.

70 gallon wood tank
 fed by 1" line.

Approximate
 water line
 location

Approximate Location
 of House



32 | 33
 — | —
 5 | 4

Found Brass Cap
 set by Oregon
 State Board of Forestry

$N65^{\circ}55'53''E$
 390.77 Feet
 point of diversion

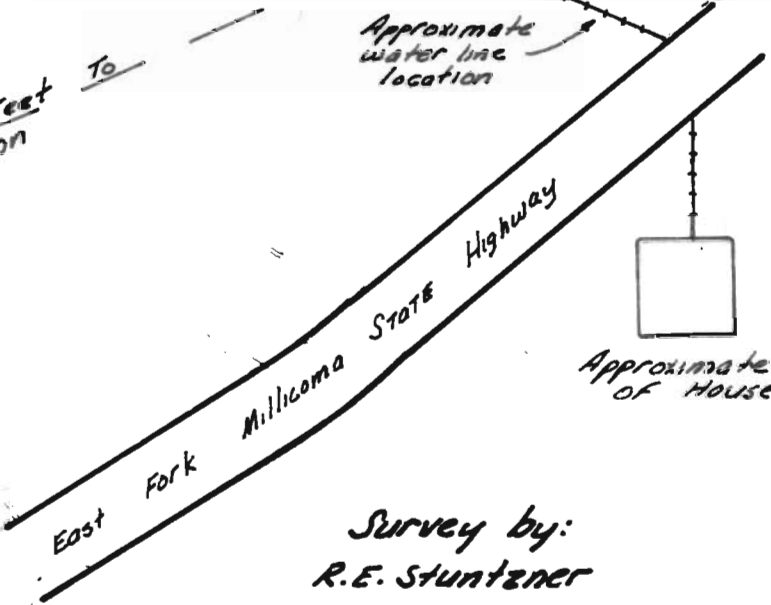

NOTE: Bearings based on
 solar observation

Legend

- Corner Found \odot
- Water Lines —+—+—+—+—
- Scale 1" = 60'

Survey by:
 R.E. Stuntzner
 1260 Golden
 Coos Bay, Ore.
 November 1, 1974



Application No. 52732
 Permit No. 39708