

# T.10S., R.2W., W.M.

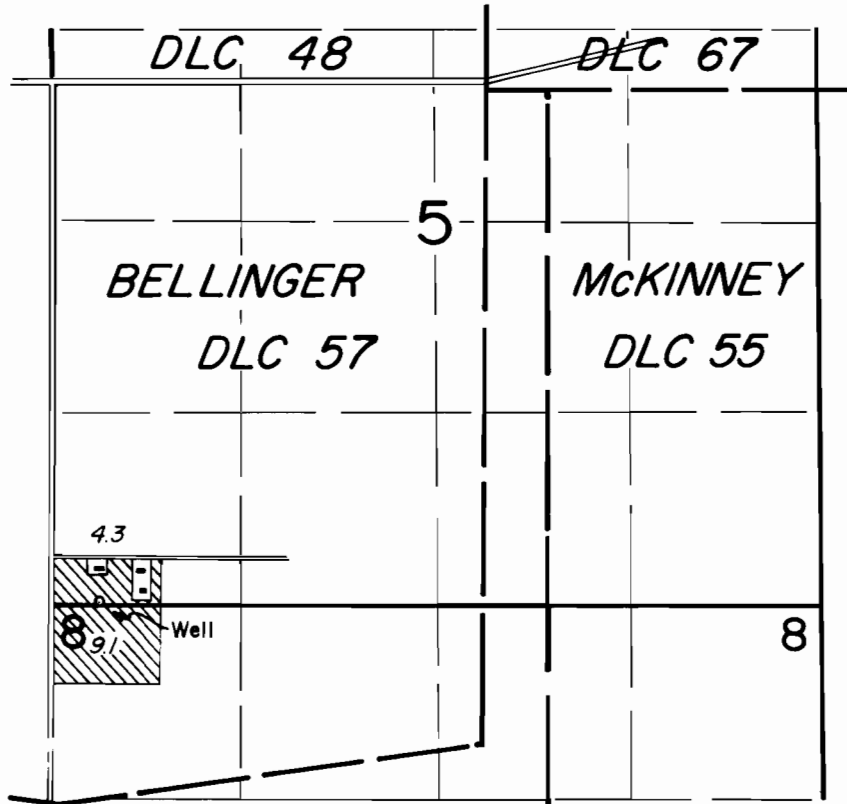

Well Loc.: 30 ft. N. & 330 ft. E., from SW corner Sec. 5

## FINAL PROOF SURVEY UNDER

Application No. G-7307. Permit No. G-6755

IN NAME OF

**BEVERLY K. HAVEN**

Surveyed OCT. 2, 1979, by *Al Brown*