

G 8964 5

76524
53554

T. 2N., R. 33E., W. M.

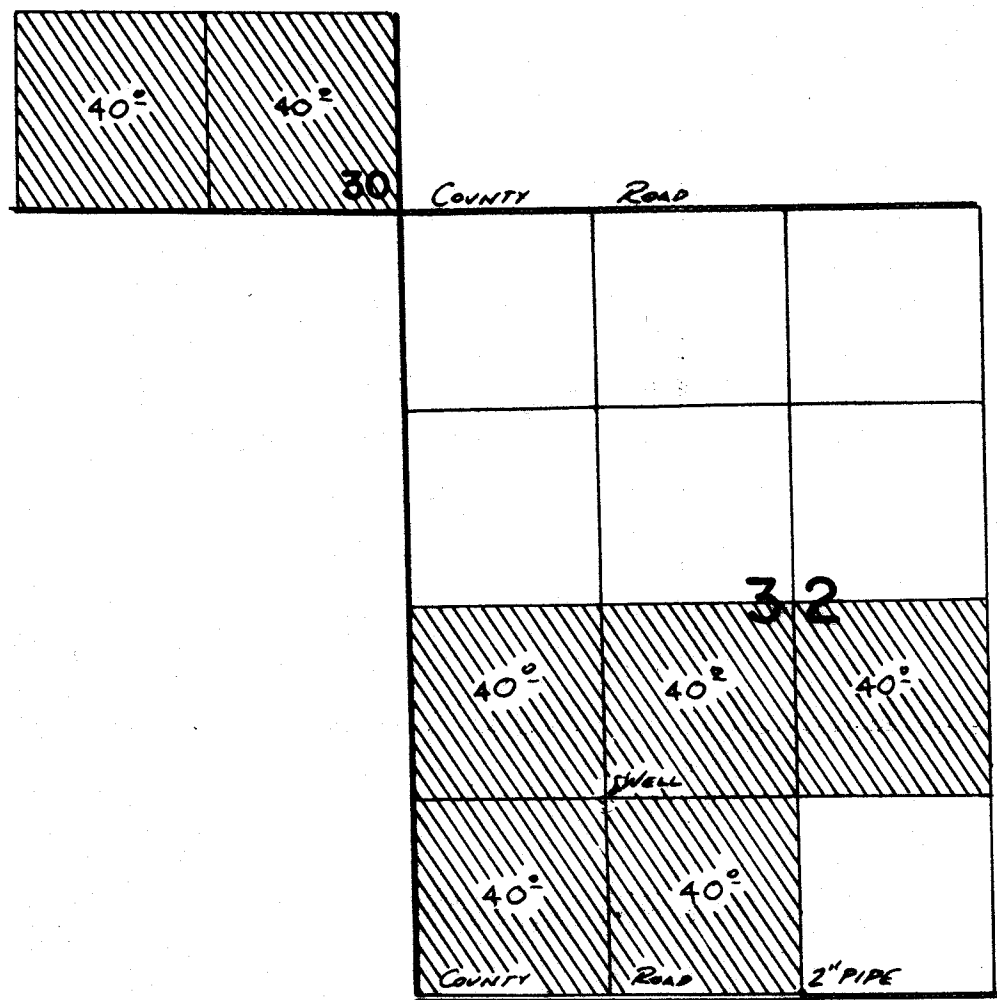

Well Loc: 1320' N & 1310' E. from SW Cor. Sec. 32

FINAL PROOF SURVEY
UNDER

Application No. G: 9613 Permit No. G8964
IN NAME OF

DAVID L. UMBARGER

Surveyed JUNE 15, 1982, by J.H. Church