

Map of F W Wilson's bepe lot  
 Situated in Sec 26 T2N R11E  
 WASCOCO COUNTY ORE  
 Scale 40 CH = 1 IN

5427  
 3998

The map of the Dollen hereby certify that this map was made from notes taken during an actual survey made by me on June 1st or 1810 and that the corrections made by me on the works described in the accompanying plat are the same as the location of the original plat and other places in the immediate vicinity and that the section thereon the area in each small section is the same as the original section and that the section of the same is located in Sec 26 T2N R11E W.M.

G. C. Smith  
 Surveyor

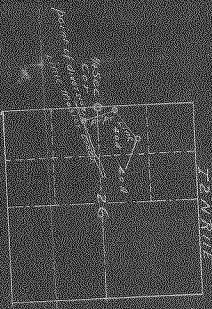

Area to be 1/4 quarter  
 5/8 N W 1/4 Sec 26

Wascoco  
 Point N