

T. 29S., R. 4W., W.M.

B.C.
N 1/4 COR.
SEC. 29

SEC 29

NENW



SCALE: 1" = 400'

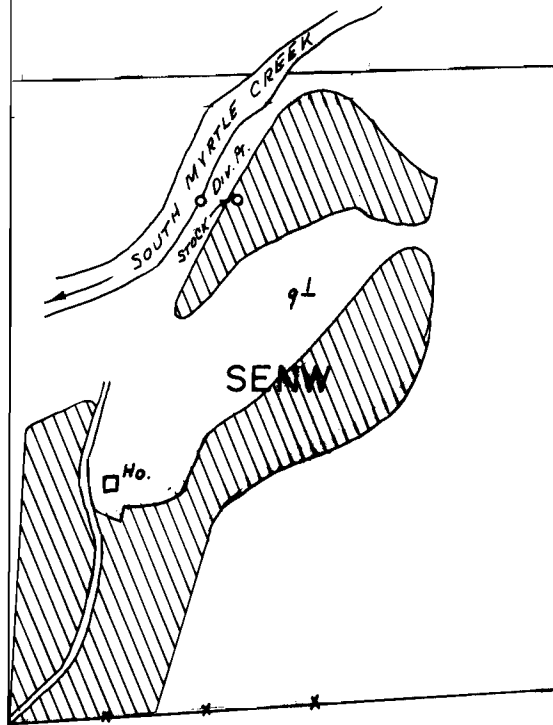

Div. Pt. Loc.: 1580' S. & 800' W. FROM N 1/4 COR. SEC. 29

FINAL PROOF SURVEY
UNDER

Application No. 56351... Permit No. 42390.....
IN NAME OF

.....**GENE B. & EVELYN R. GARY**.....

Surveyed June 12.... 19.80., by J.S. DONALDSON.

1/24/85 JEC
1/1/85
DOB. Co. 77-28-21 *amb*

RECEIVED

SEP 24 1985

WATER RESOURCES DEPT
SALEM, OREGON

T. 29S. R. 4W. W.M.
Section 29

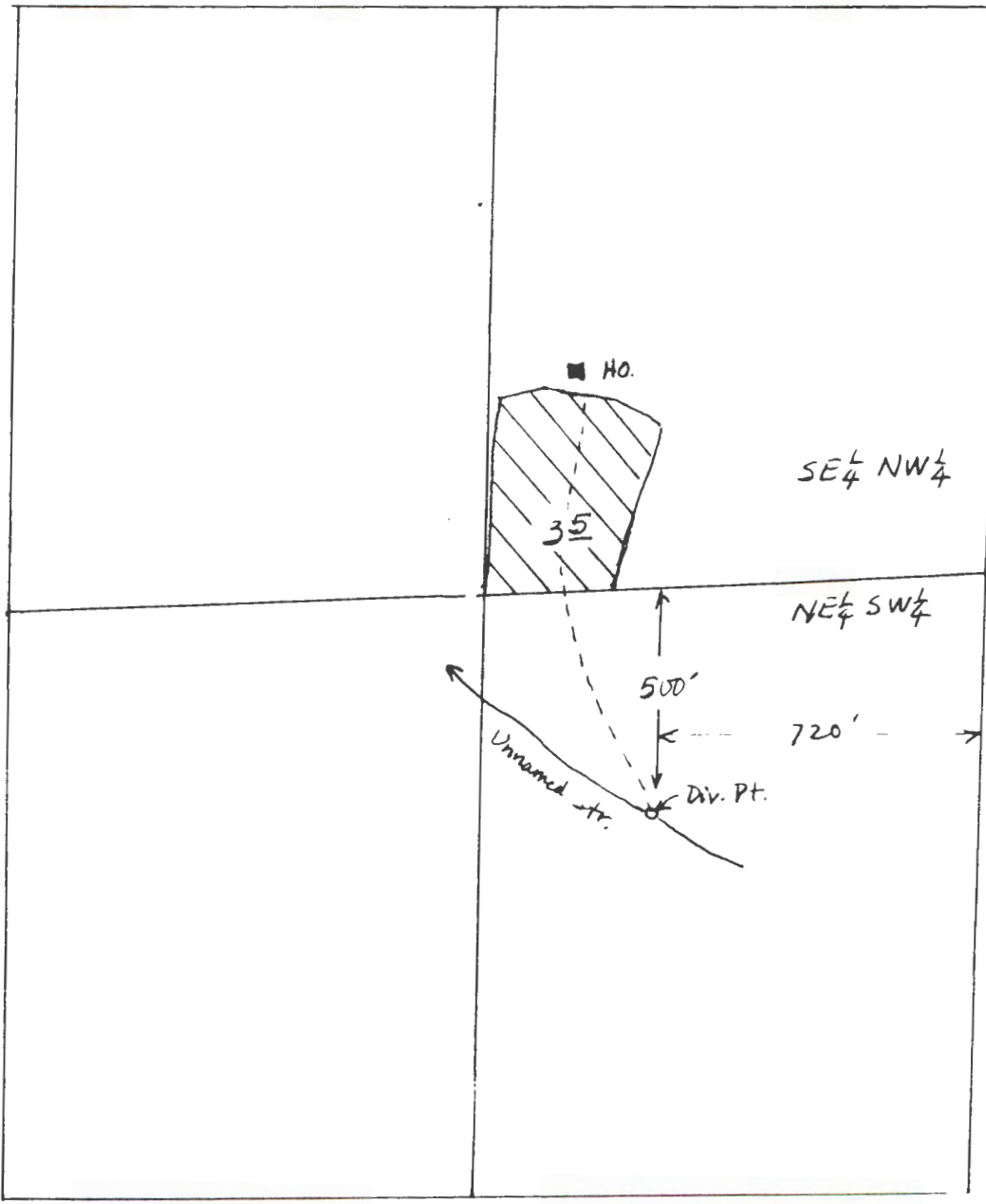

Scale 1" = 400 ft.

Application No. 68421
Permit No.