

# T. 15 S. R. 4 & 5 W. W. M.

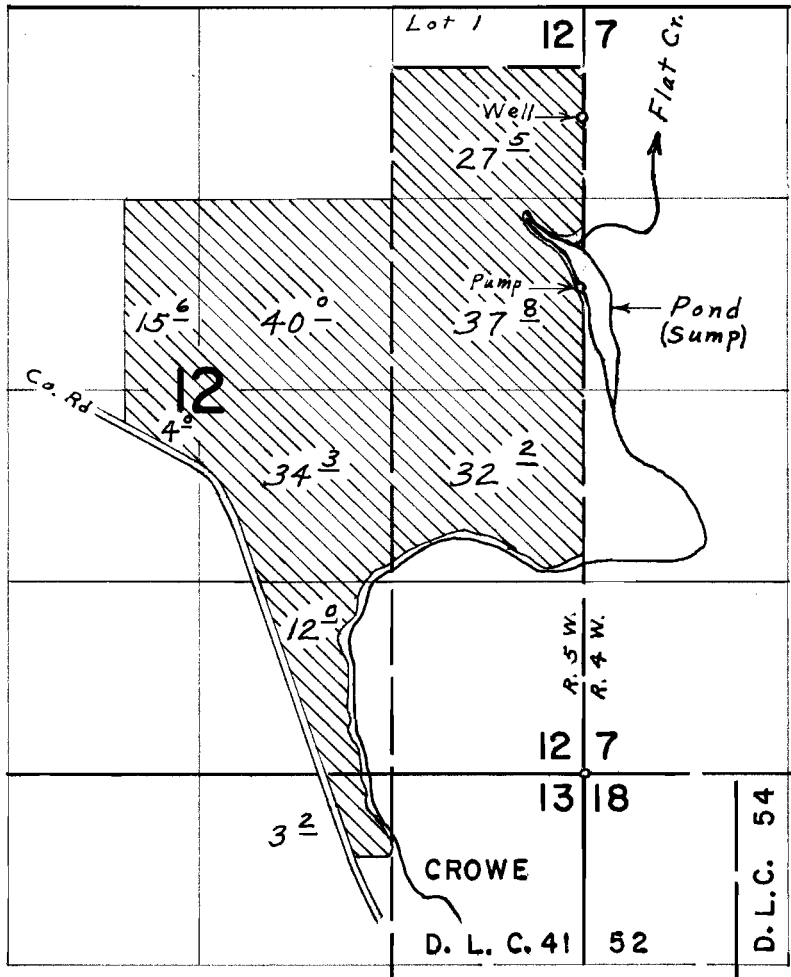

Div. Pts. located: Well, 4520' N, & 10' W.; Sump & Pond, 3340' N. & 10' W. from S.E. Cor. Sec. 12

## FINAL PROOF SURVEY

G-50670512

G-4734

G-4282

G-4031

App'd to Pa. 44560

33352

IN NAME OF

**GIBSON LAND & LIVESTOCK CO.**

Surveyed June 5, 1970, by L. E. Gould