

T. 15., R. 24E., W. M.

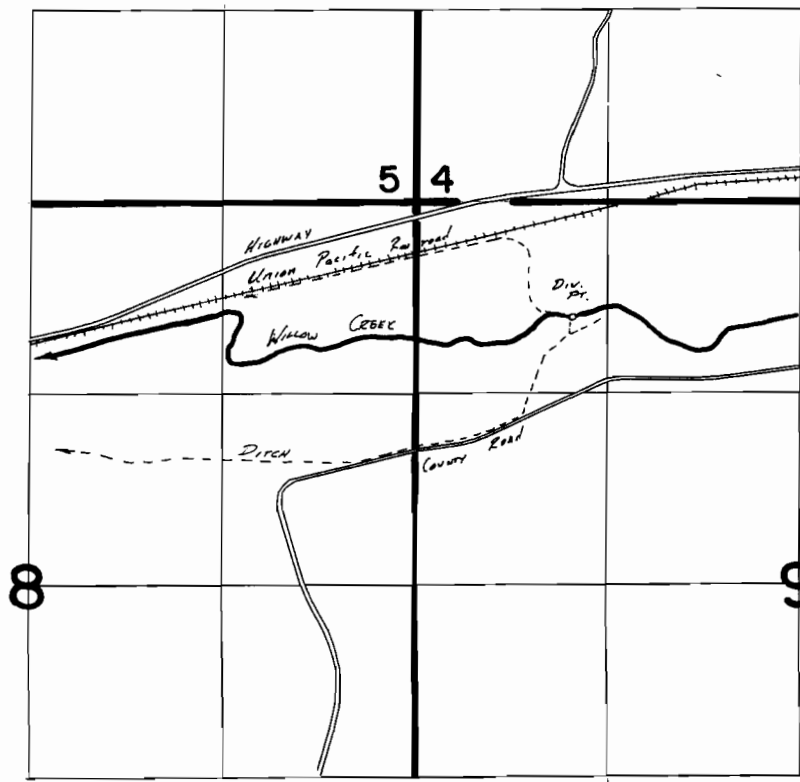

Div. Pt. LOCATED 790'S. & 1070'E FROM NW' COR. SEC 9

SCALE 1"=1320'

### FINAL PROOF SURVEY

UNDER

TRANSFER 4344

IN NAME OF

ELMER S. & LORRAINE M. LADD

Surveyed July 14, 1983, by V.L. Church