

OFFICE OF STATE ENGINEER

RECEIVED

AUG 30 1921

SALEM, OREGON

MAP
of Section 26 and 27 T. 25 S. R. 12 W. 14 M. Coos Co. Ore.
To Accompany Application for Permit
To appropriate water
by
School District #36 Coos County Ore
(Coos River Consolidated)

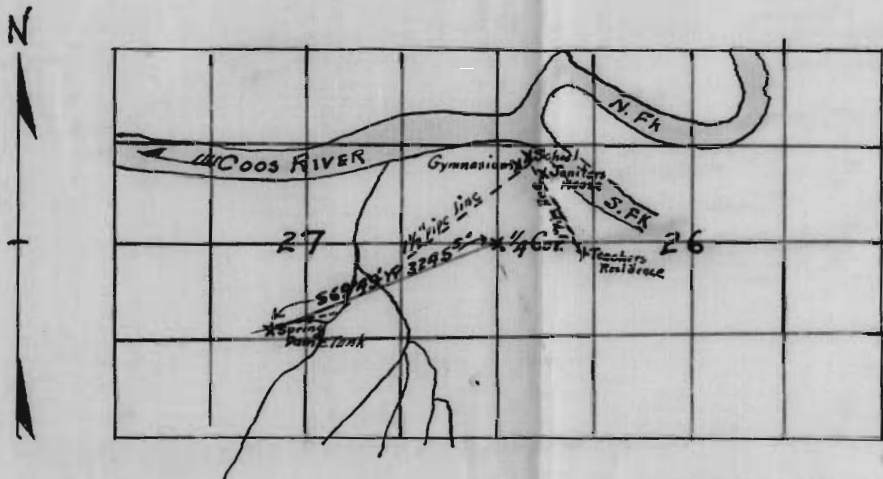

I, D. L. Buckingham, of Marshfield, Coos County Ore.
do hereby certify that this map was made from notes taken by me
during an actual survey made Aug 25, 1921 and that it correctly represents
the works described in the accompanying application together with the
location of streams, intake and terminals of the system

D. L. Buckingham

Application No. 8068
Permit No. 5210

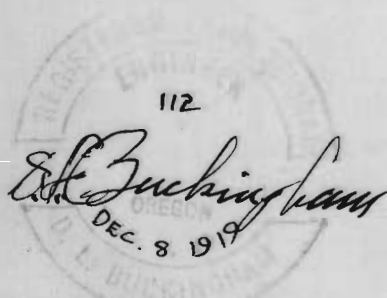

2222