

# T.27S., R.11W., W.M.

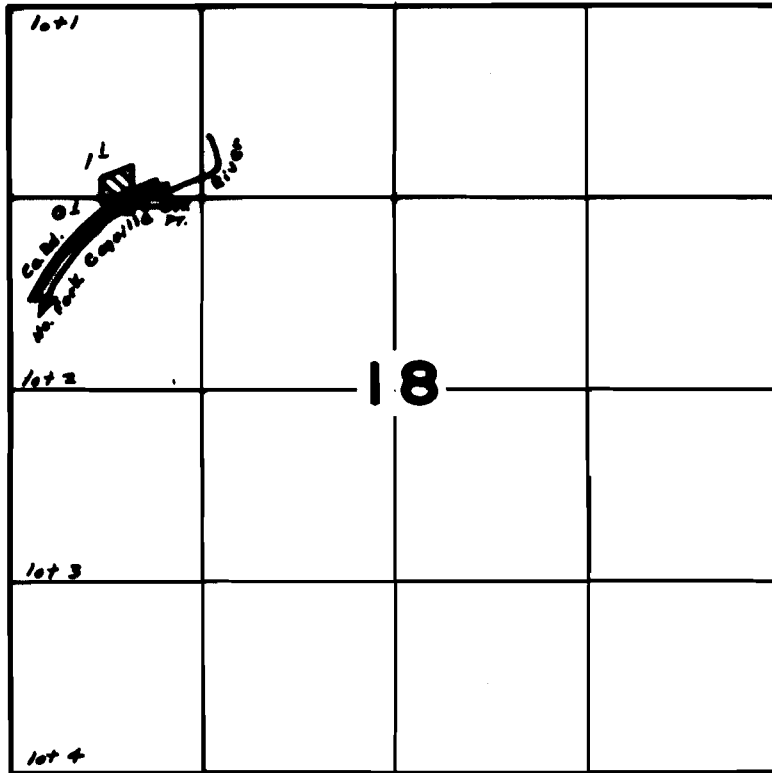

DIV. PT. : 1440'S & 820'E from NW cor.

SCALE : 4" = 1 mile

## FINAL PROOF SURVEY UNDER

Application No. 54321... Permit No. 40670.  
IN NAME OF

.....W. R. WHITNEY, Sr.....

Surveyed April 19, 1978, by B. R. SUND.....