

T. 9S. R. 39E. W. M.

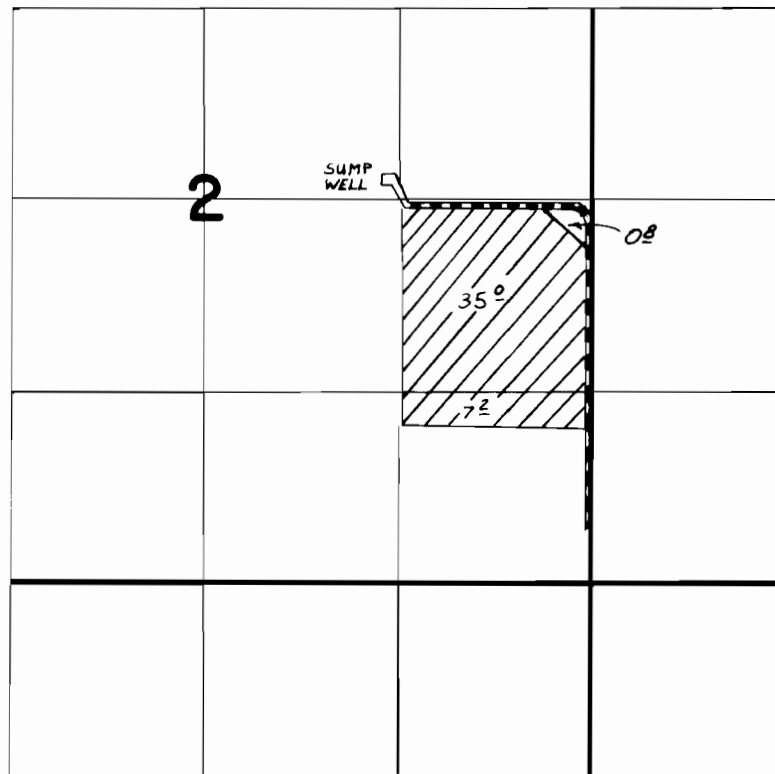

SUMP WELL LOCATED 2780' N / 1390' W FROM SE C. SEC 2

**FINAL PROOF SURVEY**  
UNDER

Application No. G-5946 Permit No. G-5645  
IN NAME OF

ORVILLE N. ROHNER

Surveyed 7-31, 1979, by V. CHURCH