

T. 4N., R. 28E., W. M.

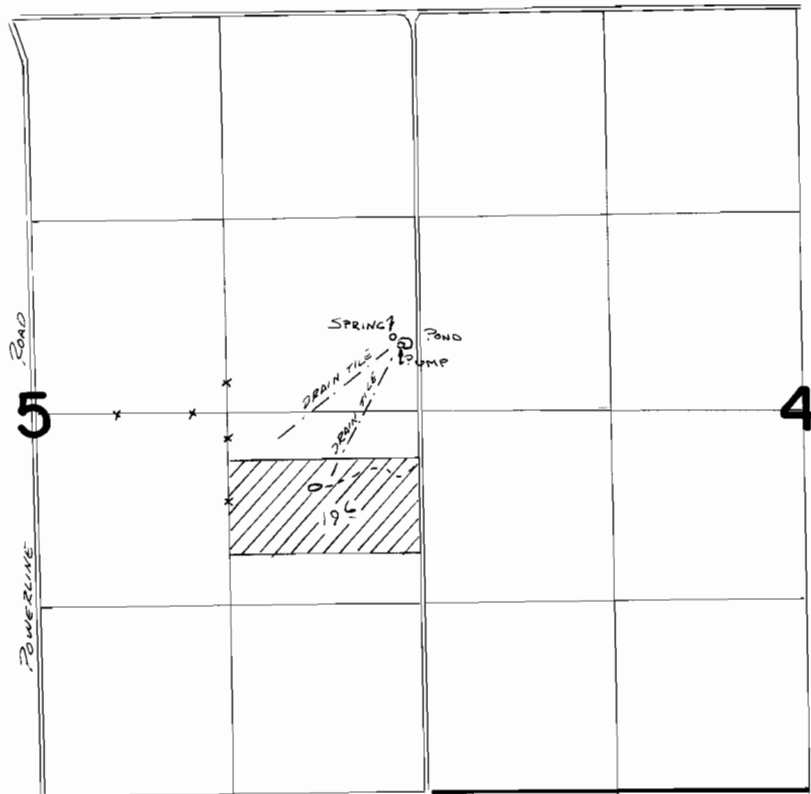

DIV. PTS. LOCATED: SPR., 510' N. & 1140' E., DRAIN, 470' N. & 1180' E. BOTH FROM S.W. COR. S.E. 1/4 N.E. 1/4 SEC. 5

FINAL PROOF SURVEY
UNDER

Application No. **54147** Permit No. **40537**
IN NAME OF

.....**SYLVIA L. MAHREN**.....

Surveyed ~~Feb. 22~~..... **1983**., by V.L. Church.....