

T. 3N. R. 28E: W.M.

T. 3N. R. 29E. W.M

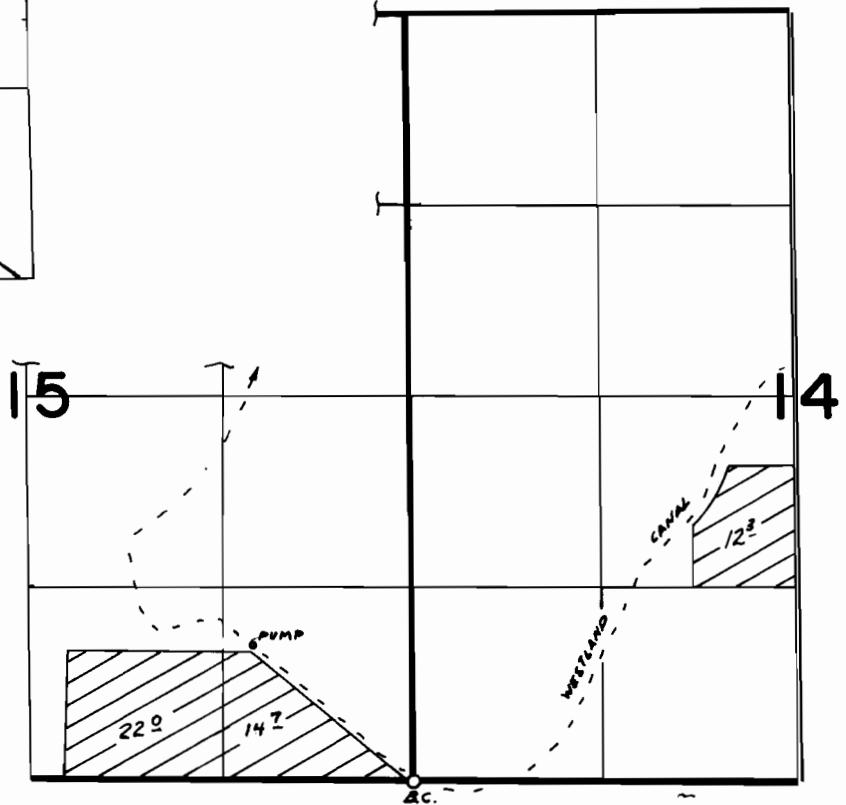
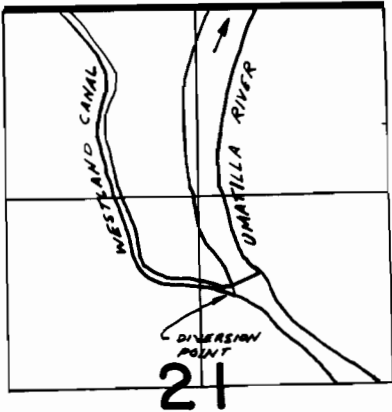

UMATILLA RIVER DIV. PT. LOCATED N 76° 45' 56" E 2913.19' FROM W1/4 COR SEC 21  
PUMP LOC. 920' N & 1090' W FROM SE COR SEC 15

**FINAL PROOF SURVEY**  
UNDER

Application No. 51645... Permit No. 38943...  
IN NAME OF

J. CLARENCE WATSON & SONS

Surveyed 2-20 1979, by R. BARWIN.....