

G-6630  
53738

T. 5N. R. 29E. W.M.

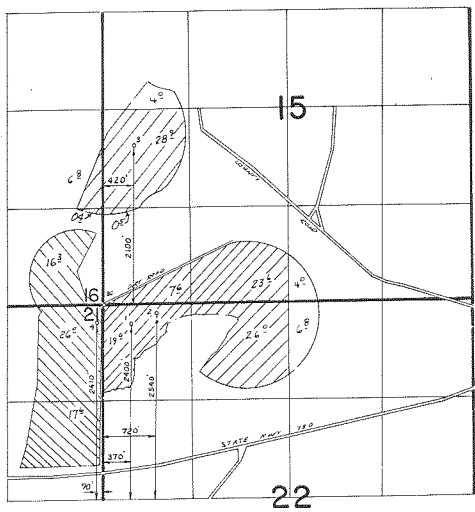

⊘ G-7200      ⊘ G-7595

**FINAL PROOF SURVEY**  
UNDER

Application No. **G-7200** Permit No. **G-6630**  
IN NAME OF

**AL CONFORTH**

Surveyed 7-3 1978, by R. BAEWIN  
2-13 79 R. BAEWIN

PL-7-23 10-1-86  
NS-3MM-321 9-24-79  
PTS-1978-P-A KC.