

G-8470
53746

T. 3N., R. 28E., W.M.

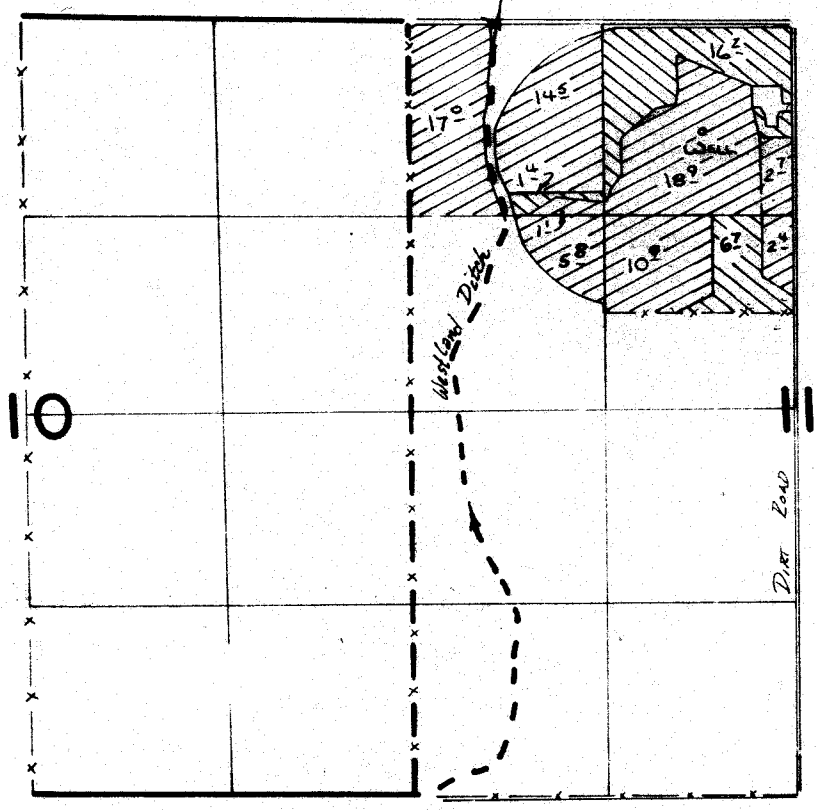

SCALE: 1" = 1320'

WELL LOCATED 1900' N. & 2040' E. FROM W 1/4 COR. SEC. 11



FINAL PROOF SURVEY
UNDER

Application No. **G-8015** Permit No. **G-8470**
IN NAME OF

BEN & DORIS COOMBES

Surveyed 2-23..... 1985., by *V.L. Church*.....