

# T. 1 N. R. 4 W. W. M.

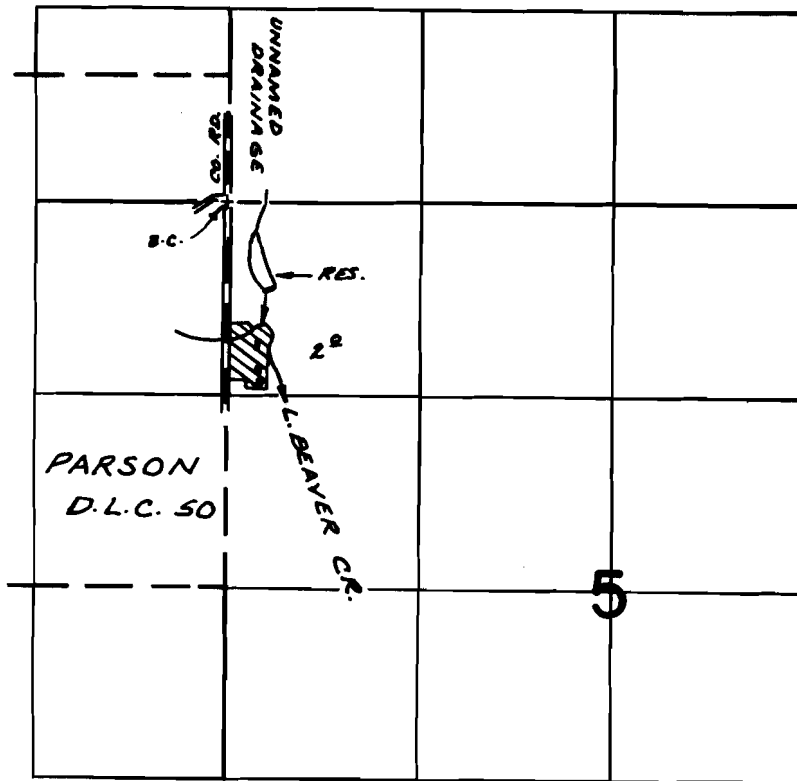

DIV. PT. LOC: 610'S. & 270'E. FROM N.W. COR. SEC. 5

## FINAL PROOF SURVEY UNDER

Application No. R-56462 / 56461 Permit No. R-6735 / 42495  
IN NAME OF

CHARLIE L. DAVIS

Surveyed OCT. 25 1979, by R. MURKIN