

T.3S. R.7E. WM.

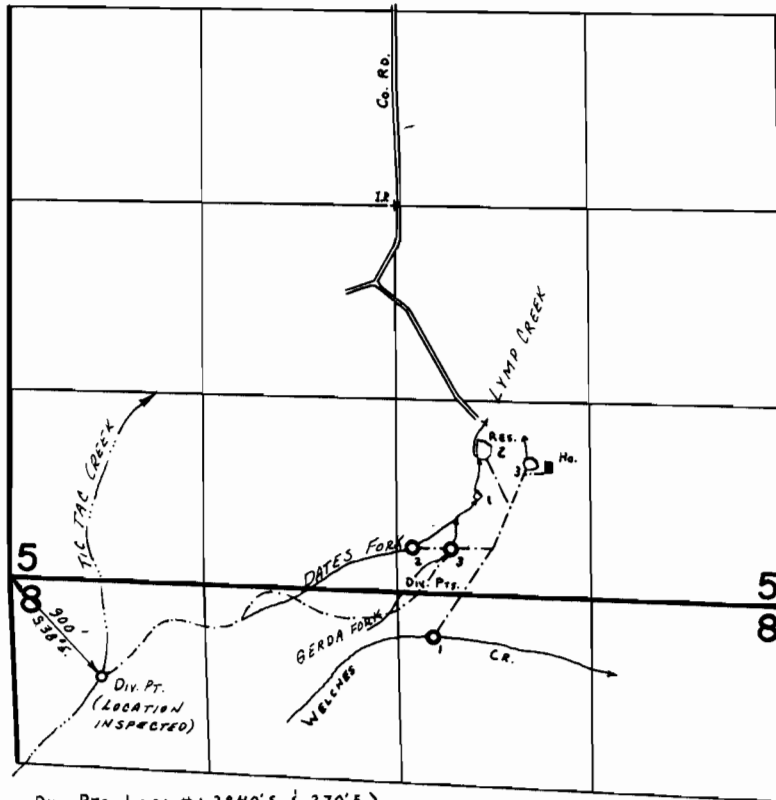

SCALE: 1" = 1320'

Div. Pts. Loc: #1-2940'S. & 270'E.  
 #2-2330'S. & 130'E.  
 #3-2330'S. & 400'E.  
 Dams Loc: #1-1950'S. & 590'E.  
 #2-1600'S. & 630'E.  
 #3-1710'S. & 930'E. } ALL FROM C. 1/4 COR. SEC. 5.

**FINAL PROOF SURVEY**

UNDER

R-54753                      R-6542  
 54754                      41001  
 R-52143                    R-6129

Application No. 51295 Permit No. 37865.....

IN NAME OF

..... LEO J. LYMP .....

Surveyed July 12, 1978, by C. L. HUGHES....

April 25 1979

Sept. 18 1984, by B.W. BISHOP

PTS-1978-M  
 PTS-1979-J

INSPECTION BWS