

T.9S., R.3E., W.M.

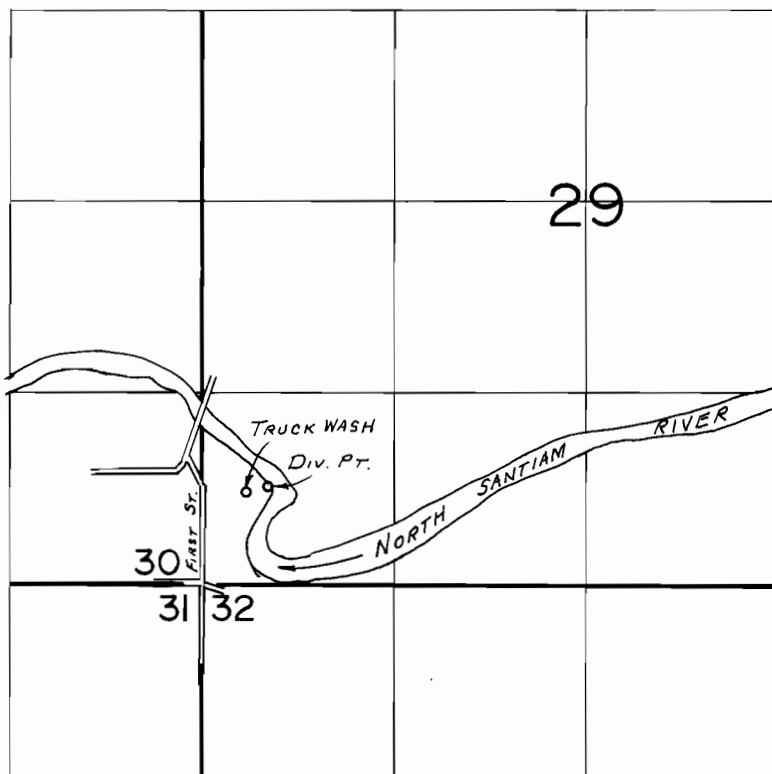

Div. Pt. Loc.: 680' N. & 450' E. FROM SW COR. SEC. 29

SCALE: 1" = 1320'

FINAL PROOF SURVEY
UNDER

Application No. 64923.. Permit No. 47487.....
IN NAME OF

.....NOYES WHITTEN.....

Surveyed April 24, 1984, by L.M.T.O.L.L.....