

T. 2S., R. 2W., W.M.

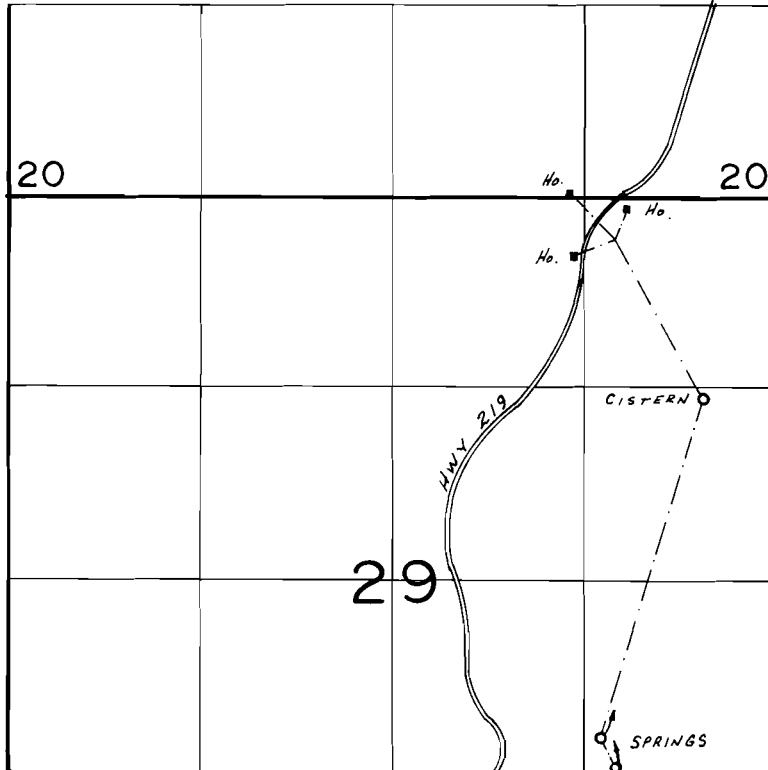

SPRINGS LOC.: 230' N. & 110' E. & 20' N. & 210' E., BOTH FROM THE SW COR. NE 1/4 SE 1/4 SEC. 29.

SCALE: 1"=1320'

FINAL PROOF SURVEY
UNDER

Application No. 57429.. Permit No. 43570.....
IN NAME OF

MILBURN ZIEGLER.....

Surveyed Sept. 26. 1984, by B.W. BISHOP.....