

T.33S., R.1W., W.M.

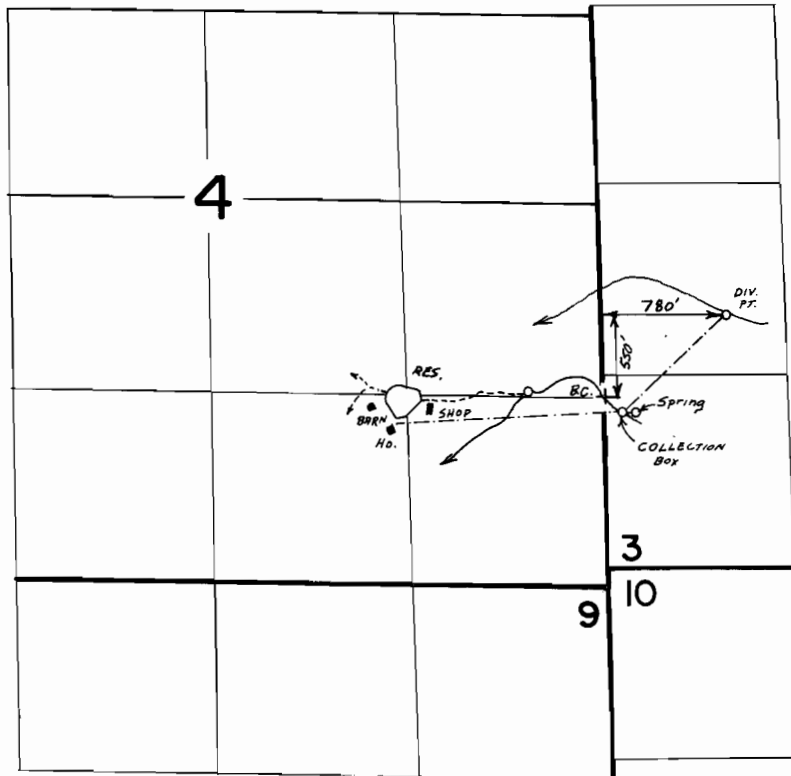

Spring: 100'S + 200'E from NE Corner SE 1/4 SE 1/4 of Section 4.

Scale 1"=1320'

FINAL PROOF SURVEY UNDER

Application No. 55.037.. Permit No. 41283.....
IN NAME OF

..CHESTER...R....LONGBRAKE.....

Surveyed Sept. 11... 19.85, by B.S. JAMES.....