

T. 33 S., R. 2 E., W.M.

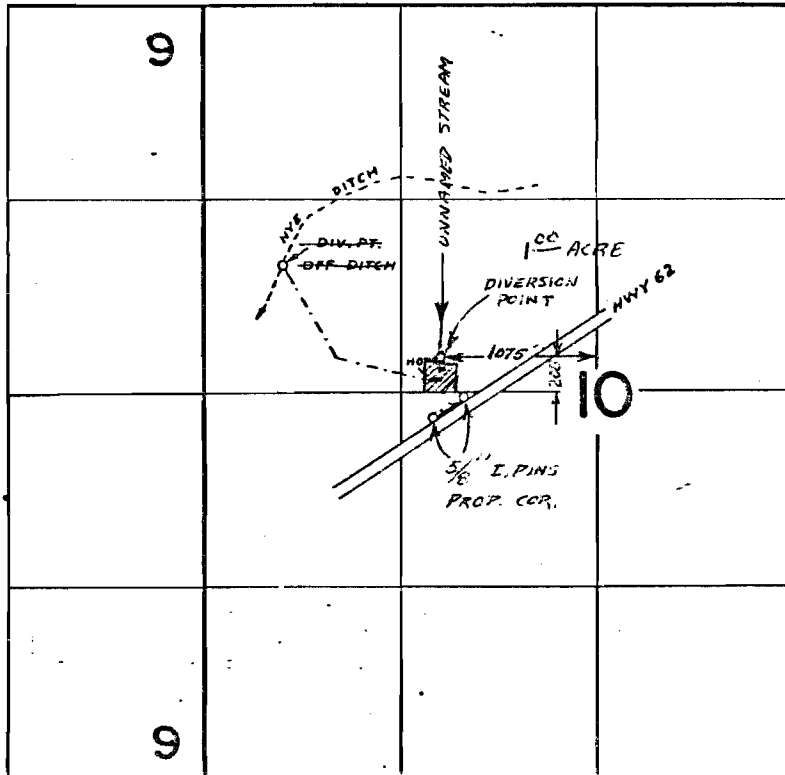

SCALE 4" = 1 MILE

~~NYE DITCH DIV. PT. LOC. - 590 FT. S. & 100 FT. E.
FROM THE W. 1/4 COR. OF SEC. 29, T. 32 S., R. 3 E.,
W.M.~~

DIVERSION POINT LOCATED: 208 FT. N. & 1075 FT. W. FROM
CENTER 1/4 COR. OF SEC. 10, T. 33 S., R. 2 E., W.M.

MINOR SURVEY

UNDER

RECEIVED

MAR 4 1983

WATER RESOURCES DEPT.
SALEM, OREGON

64525 **47430**
Application No. ~~57738~~ Permit No. ~~43472~~
IN NAME OF

~~ANNA W. S. LOR~~ MARJORIE K. JONES

Surveyed JUN. 7 1979 by B. SUND