

T. 8S. R. 46E. W.M.

Application No. G-10971
Permit No. G10102

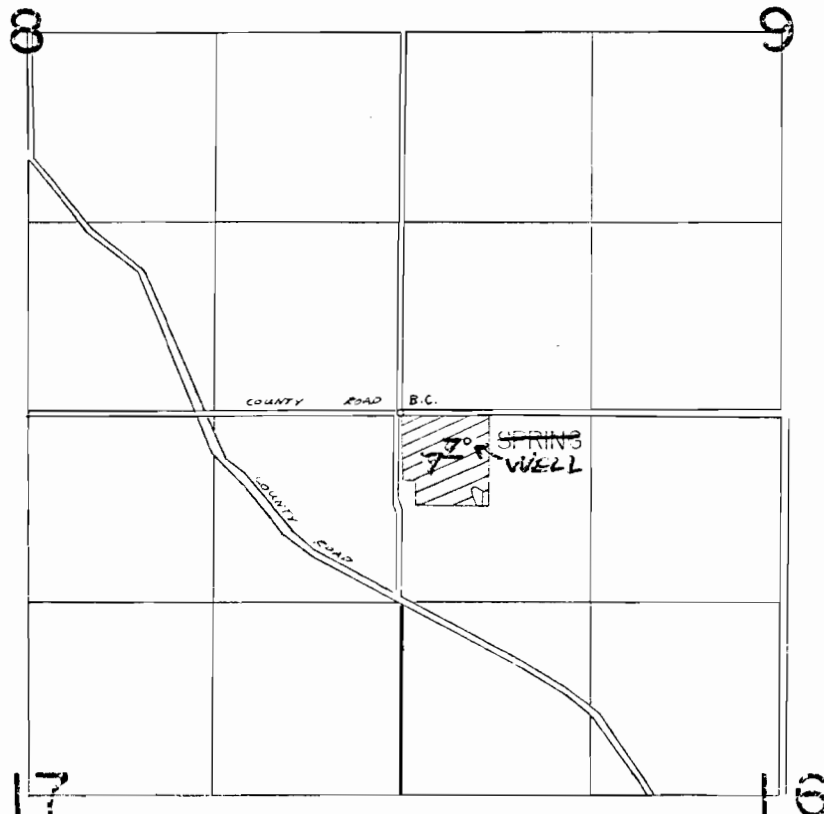

~~Spring~~ WELL LOCATED 200'S & 450'E FROM NW COR SEC 16

FINAL PROOF SURVEY
UNDER

RECEIVED

MAY 18 1983

WATER RESOURCES DEPT.
SALEM, OREGON

Application No. ~~56761~~ Permit No. ~~42800~~
IN NAME OF

.....JIM.....H.....FREEMAN.....

Surveyed 11-13 1978, by R. BARWIN.....