

T.8S., R.2W., W.M.

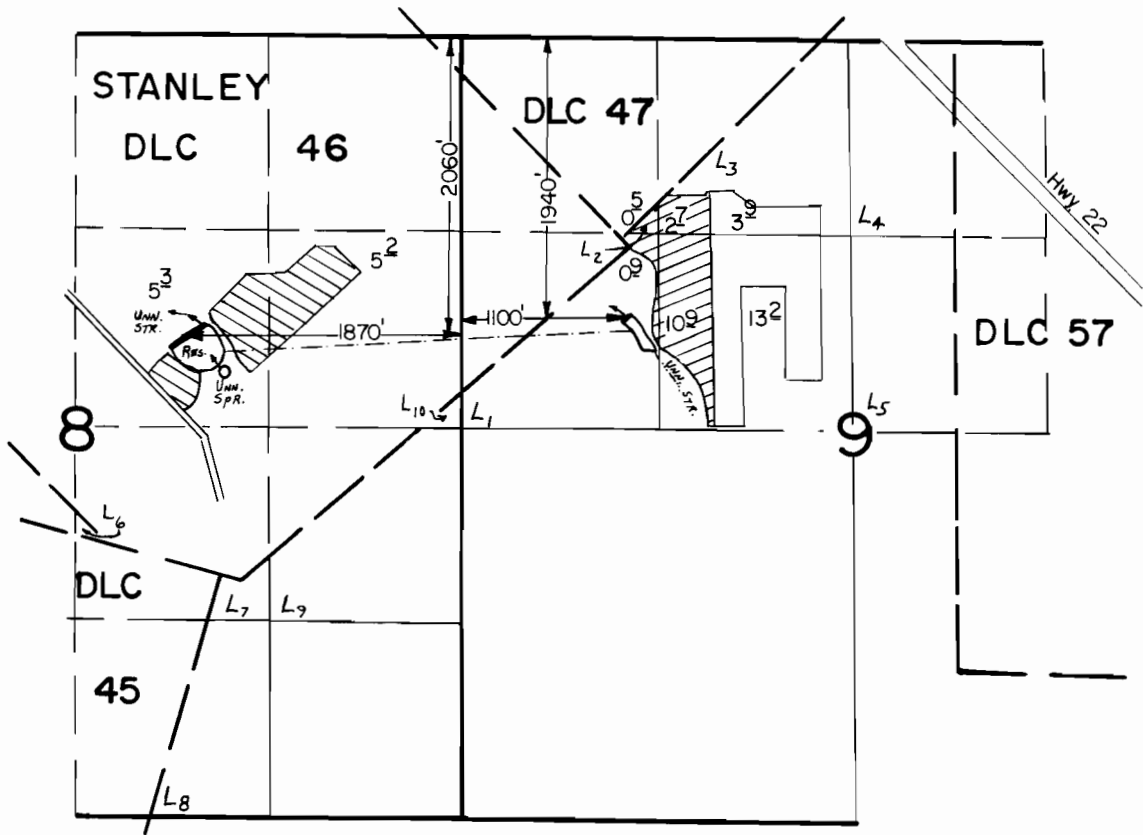

Scale: 1" = 1320'

FINAL PROOF SURVEY

UNDER

R-41570
41571
R-44427

R-4680
31009
R-5147

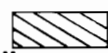
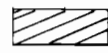

Application No. 44428... Permit No. 33183.....

IN NAME OF

OREGON STATE CORRECTIONAL INSTITUTION

Surveyed AUG. 14... 1973., by L. E. GOULD.....