

G-9189
54088

T. 4N., R. 28E., W. M.

SE 1/4 SE 1/4
SECTION 11

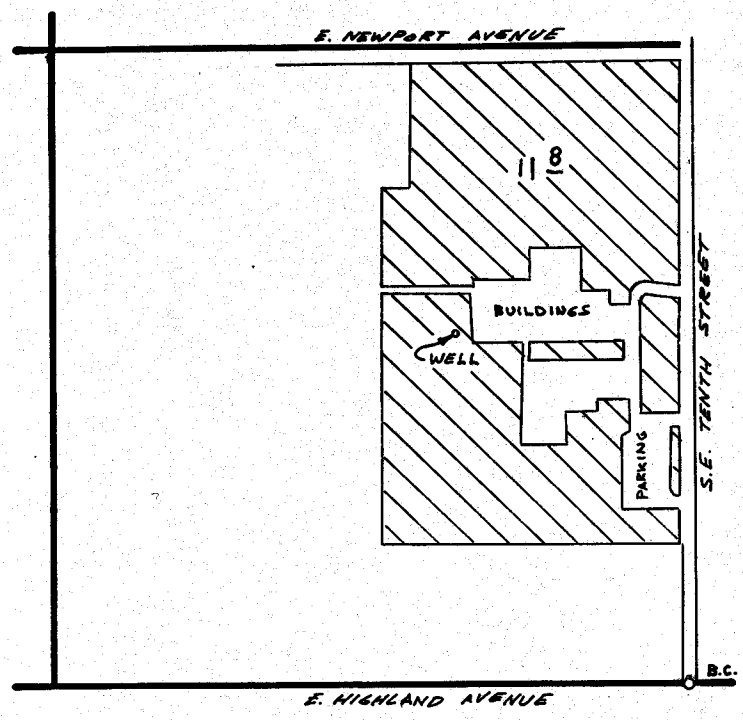

WELL LOCATED 720' N. & 490' W. FROM SE COR. SEC. 11, T. 4N. R. 28E. W.M.
1" = 400 ft.

FINAL PROOF SURVEY UNDER

Application No. G-10093 Permit No. G-9189
IN NAME OF

HERMISTON SCHOOL DIST. 8R

Surveyed Nov. 10 1981, by V. B. Church