

U-324  
C-54117

T.4N.R.28E.W.M.

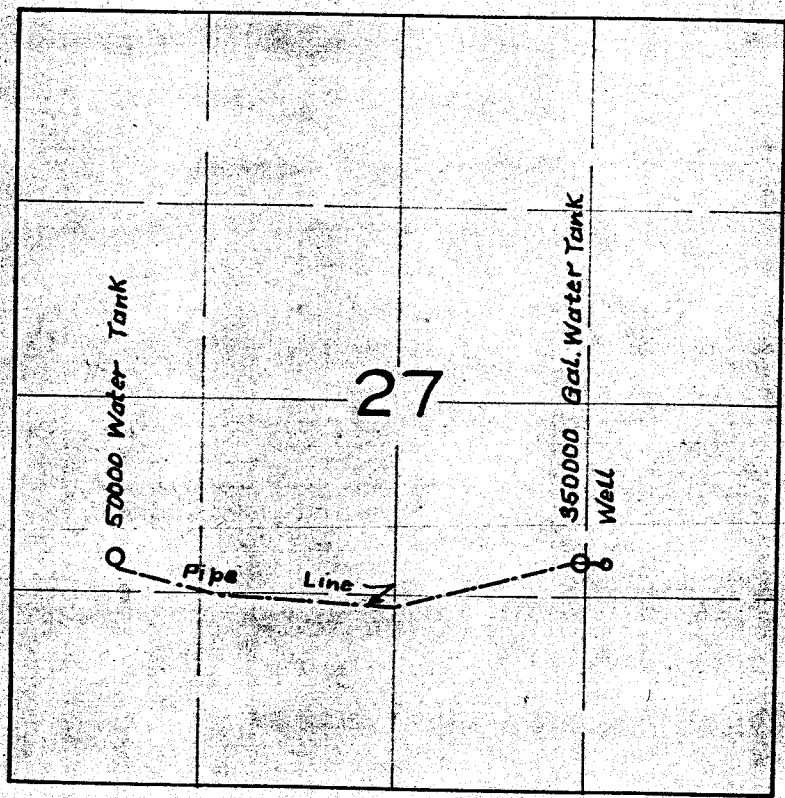

**FINAL PROOF SURVEY**

UNDER

Application No. U-324 Permit No. U-324

IN NAME OF

OREGON-WASHINGTON RAILROAD & NAVIGATION CO.

Surveyed 9 / 8 1952, by H. L. COFFMAN