

T.26S. R.6 $\frac{1}{2}$ 7W. W.M.

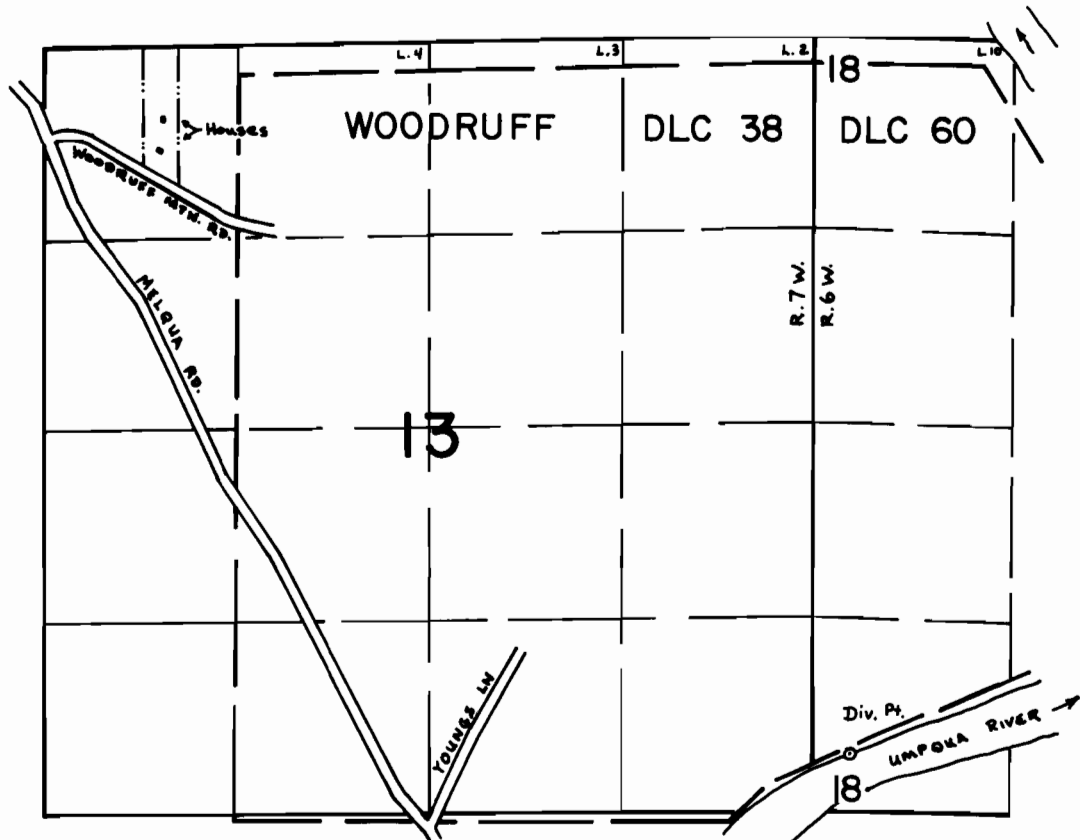

Div. Pt. Located: 400' N  $\frac{1}{4}$  240' E from the SW cor. of Sec. 18 T.26S. R.6W. W.M.

SCALE: 4" = 1 mile

**FINAL PROOF SURVEY**  
**UNDER**

Application No. 57773 Permit No. 43742  
IN NAME OF

SUE and/or MIKE DINEEN

Surveyed June 20, 1979, by S. Donaldson