

# T.3S.R.1E.W.M.

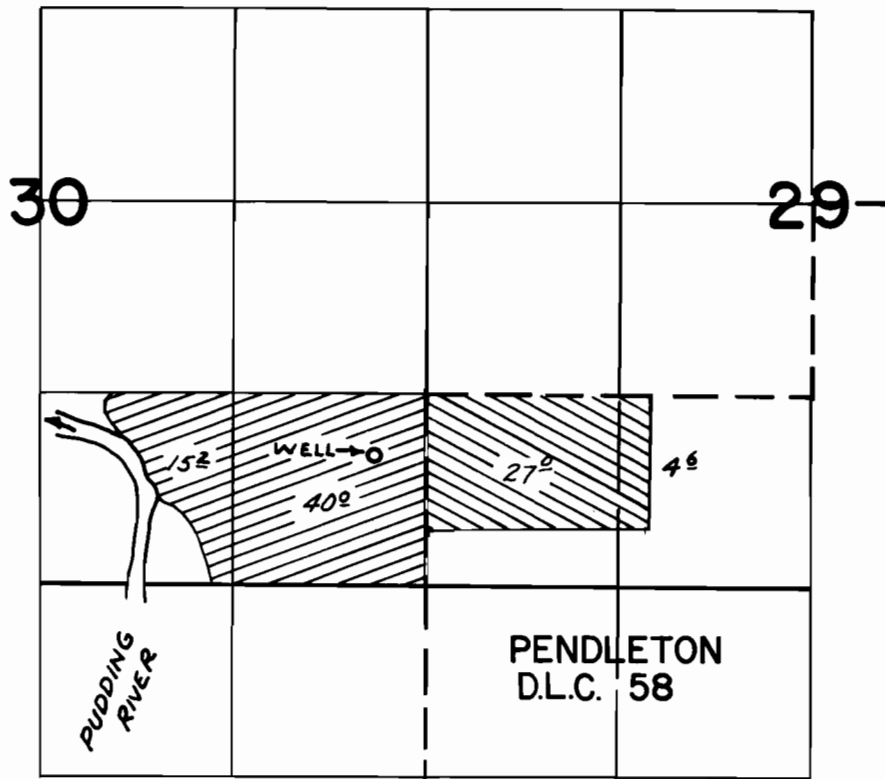

WELL LOC: 880' N. & 350' W. FROM S.E. COR. SEC. 30

-  PRIMARY
-  SUPPLEMENTAL

## FINAL PROOF SURVEY UNDER

Application No. G-9163 Permit No. G-8557  
IN NAME OF

LEROY BEALS

Surveyed MAR 4 1980, by R. MUCKEN.